

TREATED WATER TANK & FOUNDATION PLAN

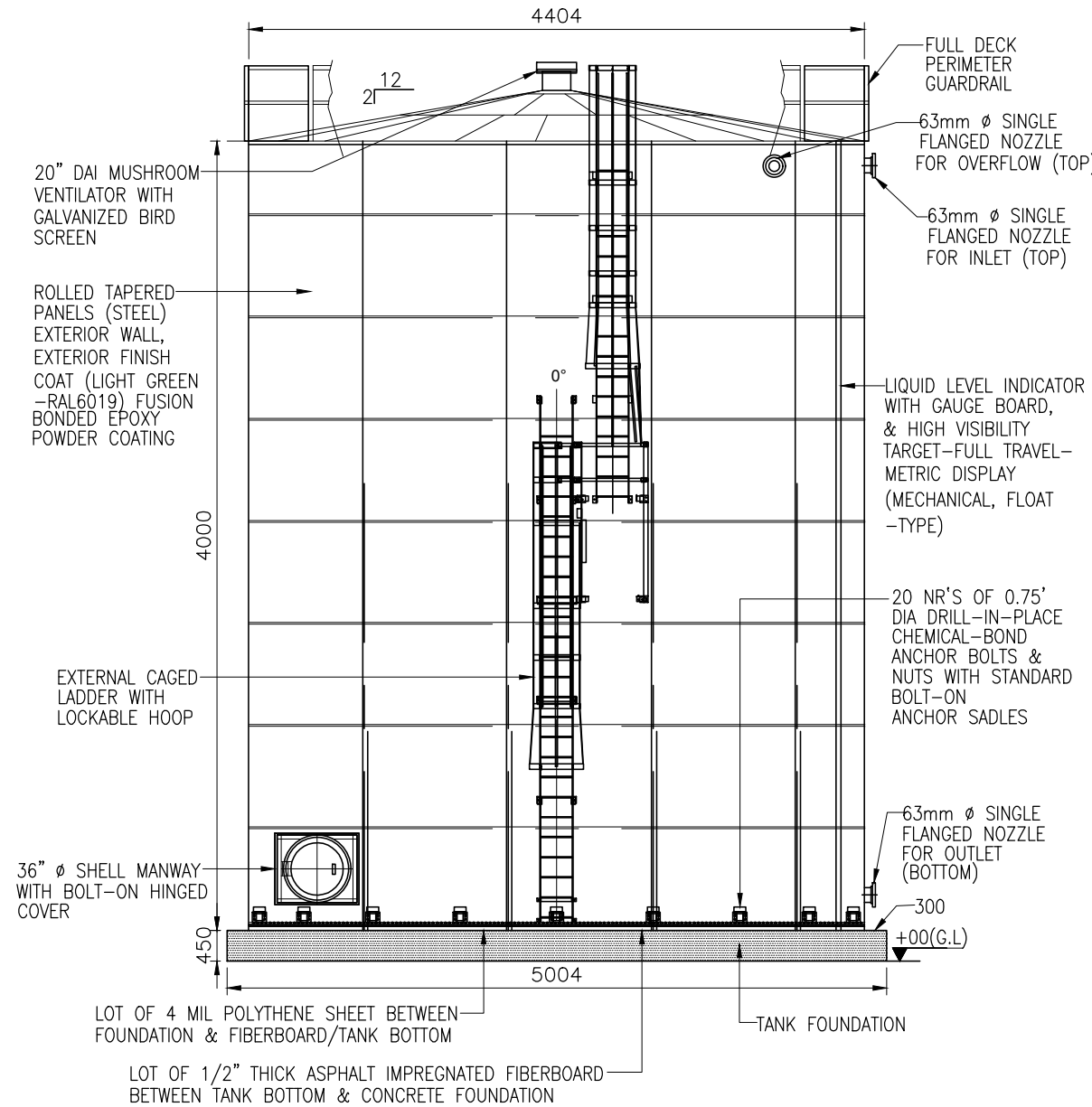
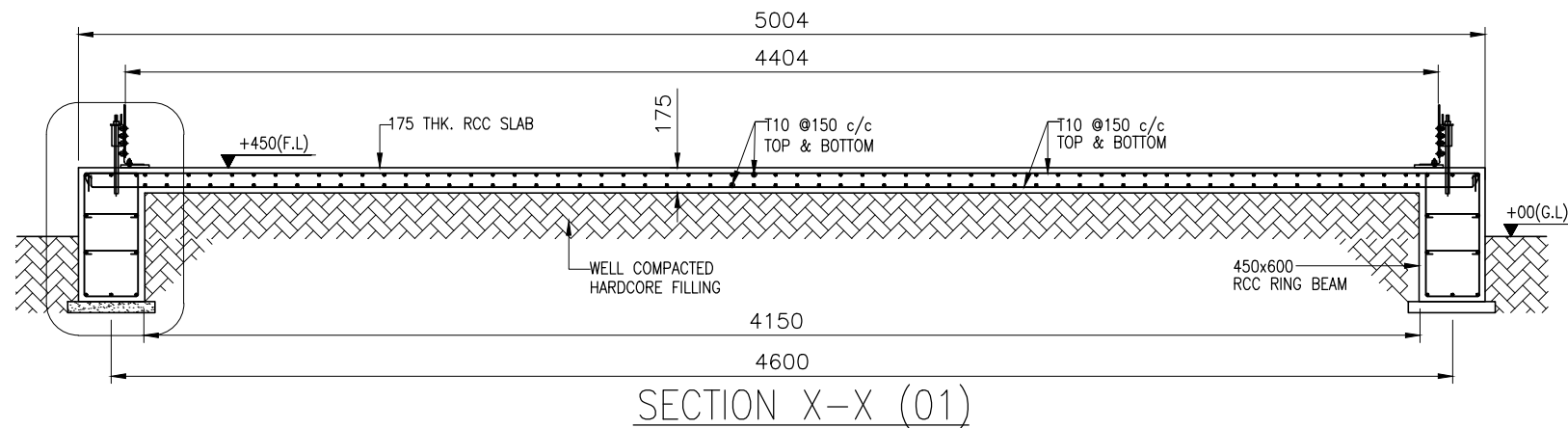
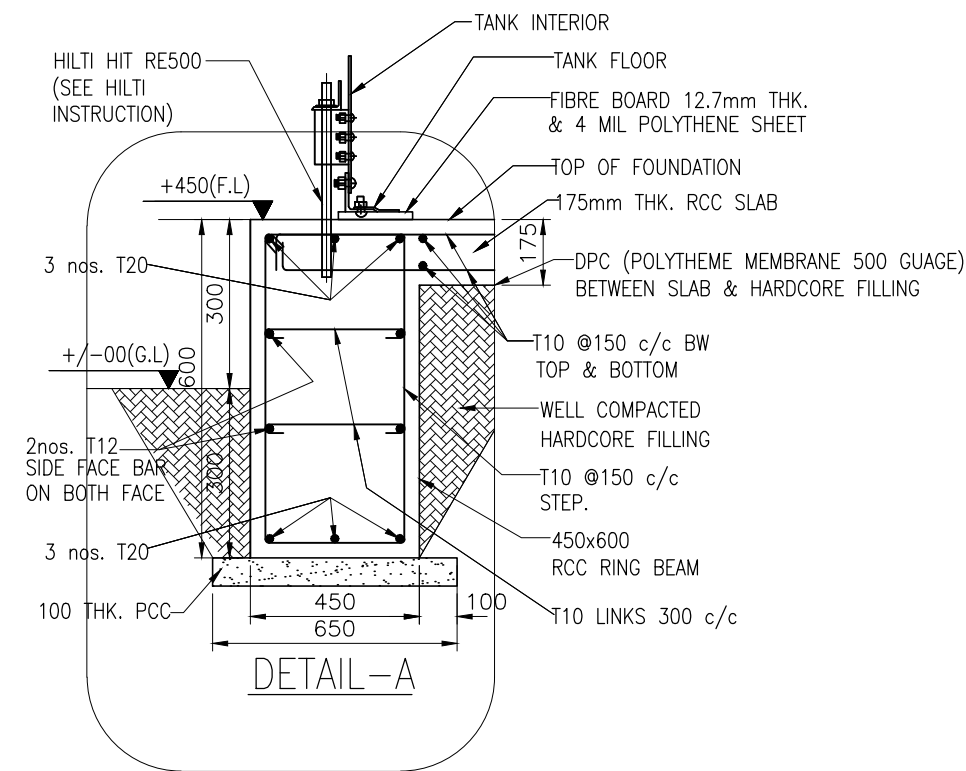

TREATED WATER TANK & FOUNDATION-ELEVATION

NOTES:-

- ALL DIMENSIONS ARE IN MILLIMETRES AND ALL LEVELS AER IN METRES, UNLESS OTHERWISE NOTED.
- DRAWINGS ARE NOT TO BE SCALED. ONLY WRITTEN DIMENSIONS ARE TO BE FOLLOWED.
- ALL CONCRETE WORK SHALL BE DESIGN GRADE C30.
- BLINDING CONCRETE WORK SHALL BE GRADE C10.
- ALL STRUCTURE WORK SHALL CONFORM TO BS 7668. GRADE 46A/ASTMA36. ALL STRUCTURAL MEMBERS SHALL BE HOT DIP GALVANIZED AND PAINTED AS PER SPECIFICATIONS.
- STEEL BARS DENOTED "T" SHALL BE HYSD BARS OF GRADE 460 CONFIRMING TO BS 4449
- NET SBC OF 15T/SQM IS CONSIDERED IN THE DESIGN.
- CLEAR COVER TO REINFORCEMENT
 - BEAM -40mm
 - SLAB -25mm



VIVEK V. PAGNIS
(STRUCTURAL ENGINEER)

TENDER PURPOSE

					CLIENT	MINISTRY OF ENVIRONMENT AND ENERGY MALE REPUBLIC OF MALDIVES				
					PROJECT	PROVISION OF RAINWATER HARVESTING SYSTEM IN 8 ISLANDS				
					ASSIGNMENT	CONSULTANCY SERVICES FOR DESIGN AND SUPERVISION OF RAINWATER HARVESTING SYSTEM IN AA. HIMANDHOO, AA. BODUFULHADHOO, AA. MATHIVERI, ADH. KUNBURUDHOO, ADH. DHIGURAH, DH. BANDIDHOO, DH. HULHIDHIELI, DH. MEEDHOO, MALDIVES [PACKAGE - 3]				
					DRAWING TITLE	TYPICAL DRAWING OF TREATED WATER STORAGE TANK AA. MATHIVERI				
					APPROVED	VVP	CHECKED	SSS	DESIGNED	SPP
					SCALE	AS SHOWN	DATE	FEB 2018	DRAWING NUMBER	Aa. Mathiveri/WS/08B
					REVISION					
					CONSULTANT	SHAH TECHNICAL CONSULTANTS PVT. LTD., INDIA IN ASSOCIATION WITH DEVELOPMENT TECHNOLOGIES MALDIVES, MALDIVES				