

BUILDING SERVICES DRAWINGS OF

PROPOSED 2 STOREY BUILDING AT

VILIMALE' FISH MARKET

For LOCAL GOVERNMENT AUTHORITY

By Epoch Associates Pvt. Ltd



Legend

- 
- 13A Twin Socket
- 
- 13A Power Socket
- 
- 15A Switched Socket @ H.L.
- 
- 13A Power Socket in Weatherproof Polycarbonate Enclosure
- 
- 15A Switch @ 1200mm From F.F.L.
- 
- Distribution Board
- 
- HL. High Level
- 
- Telephone Outlet
- 
- Computer Network Outlet
- 
- Emergency Light
- 
- Main Incoming Cable For Power In 110Ø PVC Duct Below Ground Slab

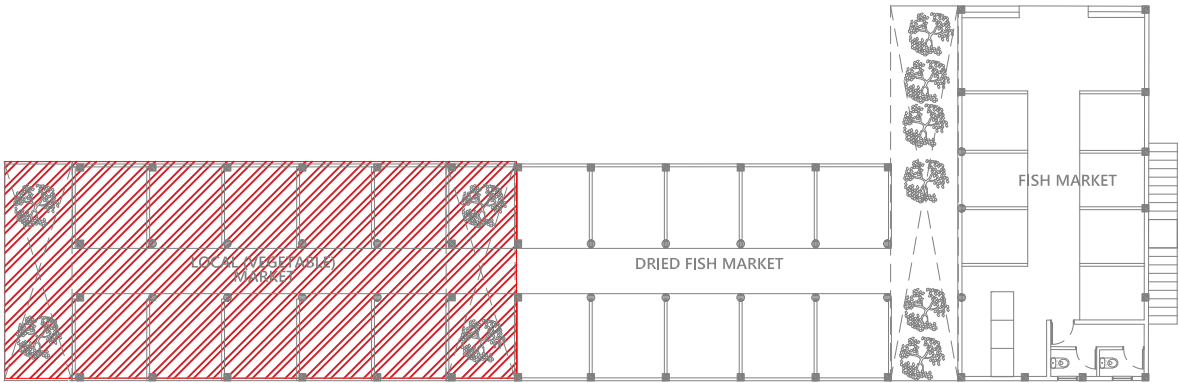
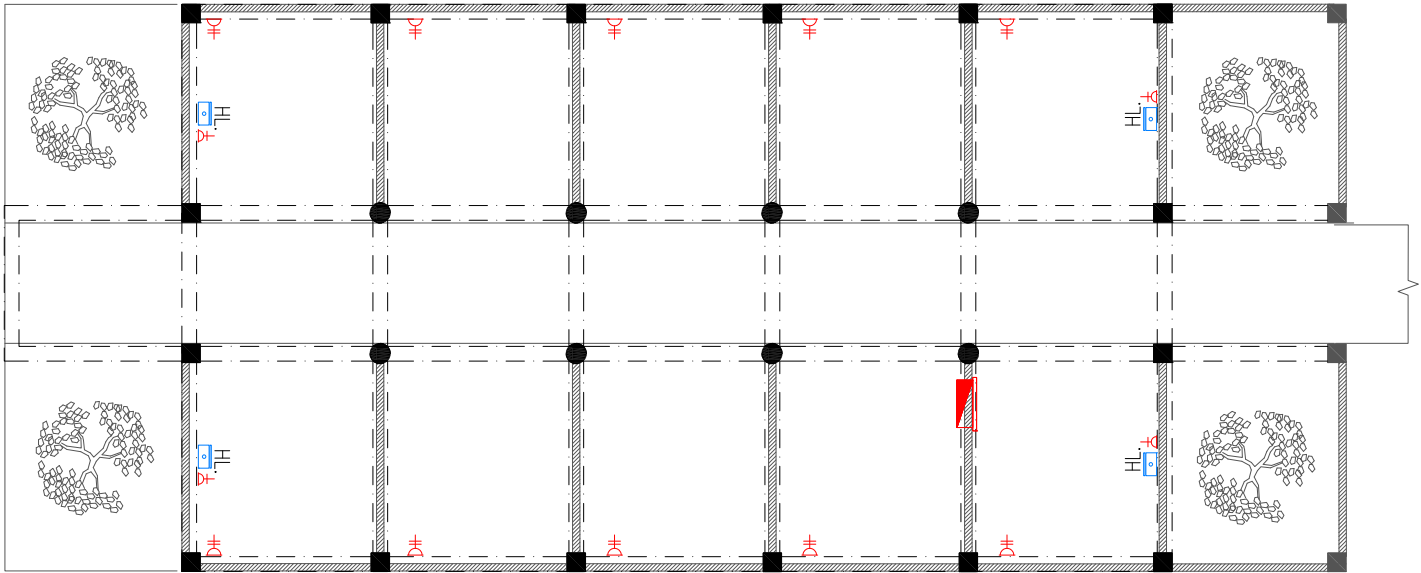

GROUND FLOOR POWER AND ACV LAYOUT-1

1:100

PROPOSED 02 STOREY BUILDING AT
**VILIMALE' FISH
MARKET**

Client:
**LOCAL GOVERNMENT
AUTHORITY**

November 2019

Services By: Mohamed Rassam
Checked By:
Drawn By: Hussain Rasheed



T: +960 333 3528 E: info@epochassociates
W: www.epochassociates A: M. Alagasshooshaige,
Fareedhee Magu Male' Republic of Maldives

Rev: ---

Page: PAC-01

Legend

- 13A Twin Socket
- 13A Power Socket
- 15A Switched Socket @ H.L.
- 13A Power Socket in Weatherproof Polycarbonate Enclosure
- 15A Switch @ 1200mm From F.F.L.
- Distribution Board
- HL. High Level
- Telephone Outlet
- Computer Network Outlet
- Emergency Light
- Ceiling Mounted Exhaust Fan 90m3/hr
- Main Incoming Cable For Power In 110Ø PVC Duct Below Ground Slab

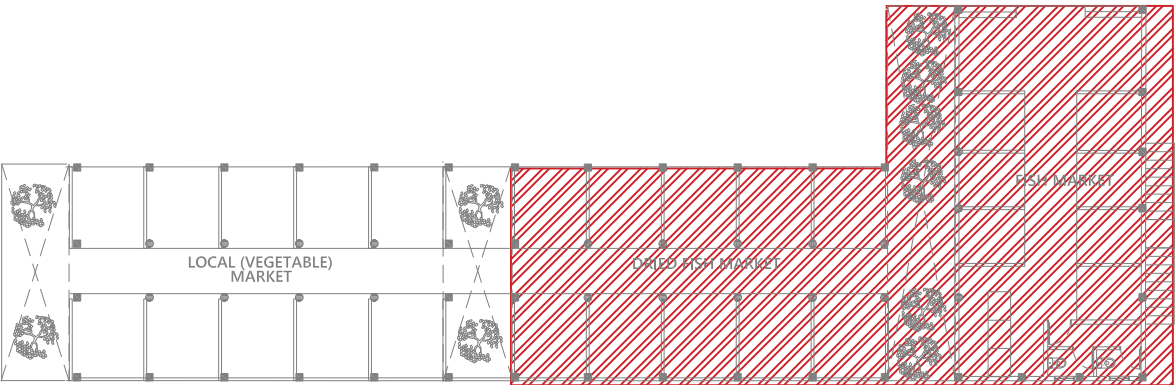
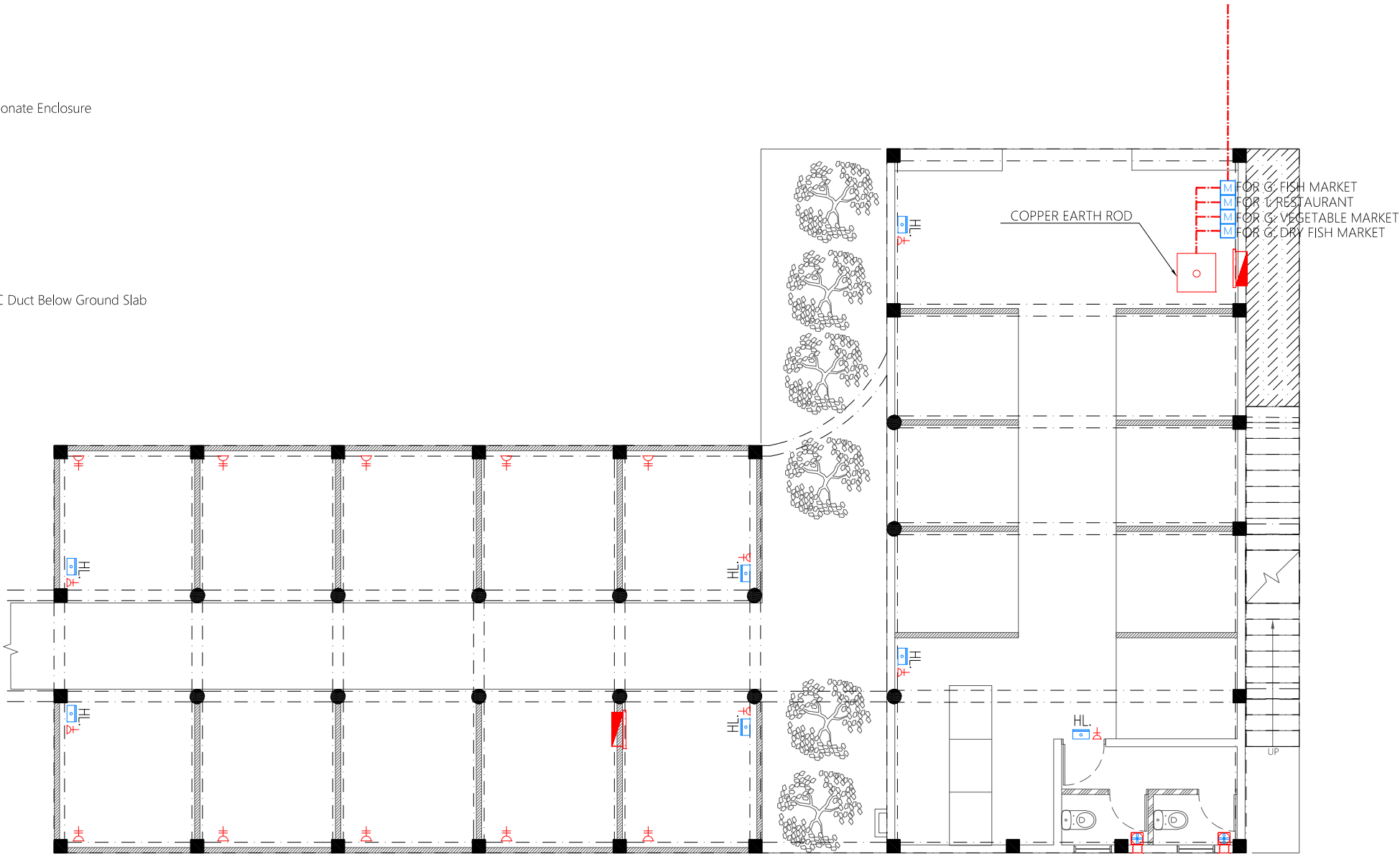

GROUND FLOOR POWER AND ACV LAYOUT-2

PROPOSED 02 STOREY BUILDING AT
**VILIMALE' FISH
MARKET**

Client:
**LOCAL GOVERNMENT
AUTHORITY**

November 2019

Services By: Mohamed Rassam
Checked By:
Drawn By: Hussain Rasheed



T: +960 333 3528 E: info@epochassociates
W: www.epochassociates A: M. Alagashchuge,
Fareedhee Magu Male' Republic of Maldives

Rev: ---

Page: ---
PAC-02

Legend

- 13A Twin Socket
- 13A Power Socket
- 15A Switched Socket @ H.L.
- 13A Power Socket in Weatherproof Polycarbonate Enclosure
- 15A Switch @ 1200mm From F.F.L.
- Distribution Board
- HL. High Level
- Telephone Outlet
- Computer Network Outlet
- Emergency Light
- Main Incoming Cable For Power In 110Ø PVC Duct Below Ground Slab

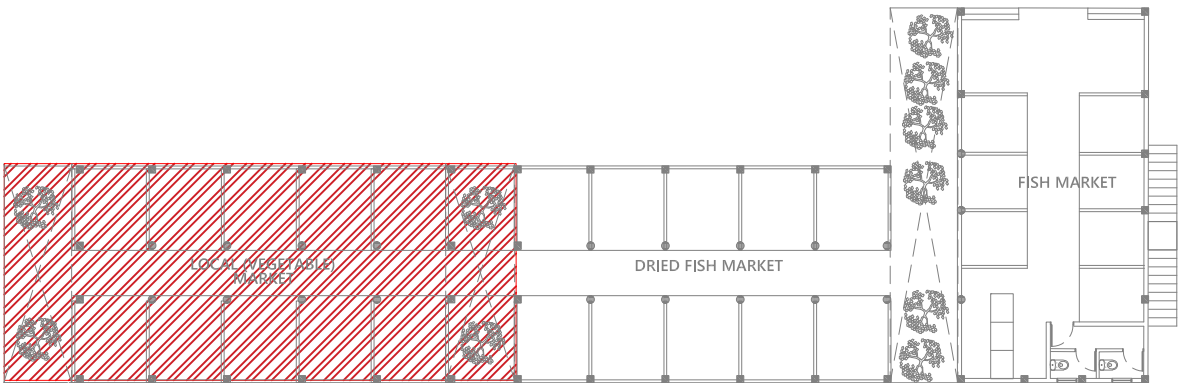
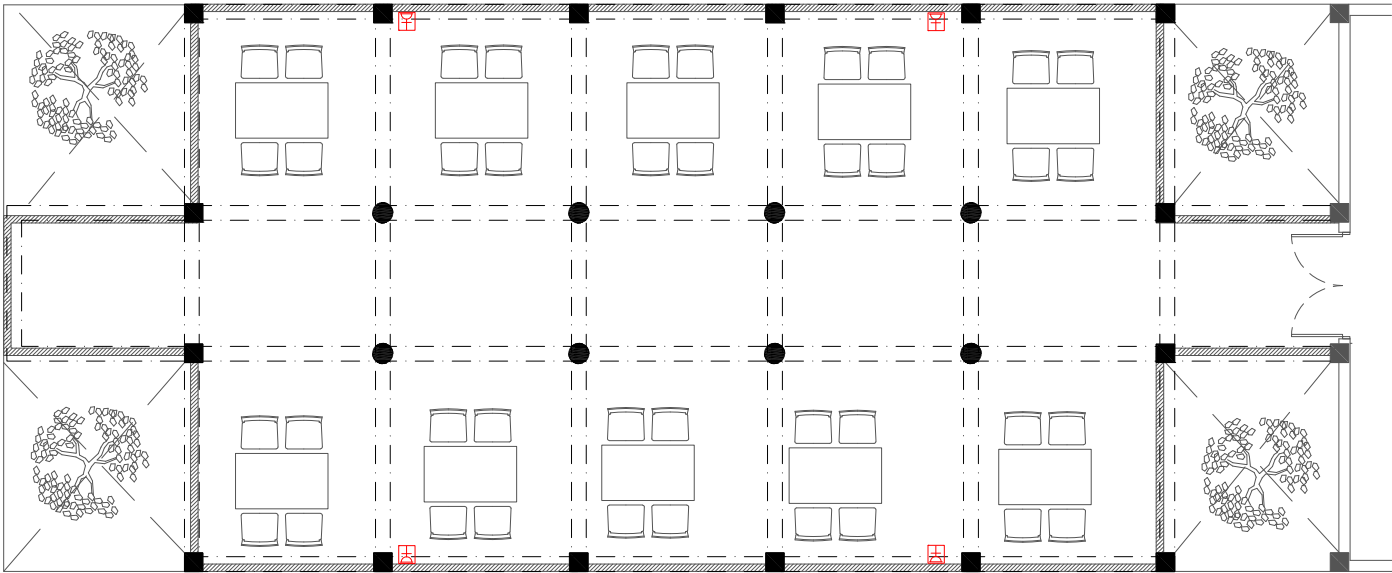

FIRST FLOOR POWER AND ACV LAYOUT-1

1:100

PROPOSED 02 STOREY BUILDING AT
**VILIMALE' FISH
MARKET**

Client:
**LOCAL GOVERNMENT
AUTHORITY**

November 2019

Services By: Mohamed Rassam
Checked By:
Drawn By: Hussain Rasheed



T: +960 333 3528 | E: info@epoch.associates
W: www.epoch.associates | A. M. Abgasdhooshege,
Fareedhee Magu Male' Republic of Maldives

Rev: ---

Page: PAC-03

- Legend
- 13A Twin Socket
 - 13A Power Socket
 - 15A Switched Socket @ H.L.
 - 13A Power Socket in Weatherproof Polycarbonate Enclosure
 - 15A Switch @ 1200mm From F.F.L.
 - Distribution Board
 - HL. High Level
 - Telephone Outlet
 - Computer Network Outlet
 - Emergency Light
 - TV Socket Outlet
 - Main Incoming Cable For Power In 110Ø PVC Duct Below Ground Slab

- Legend
- Refrigerant Pipes
 - 25Ø Condensate Drain Pipe
 - 40Ø Condensate Drain Riser Pipe
 - Kitchen Hood
 - Ceiling Mounted Exhaust Fan 90m3/hr
 - AC Wall Mount Air Conditioner
 - CU Outdoor Condensing Unit

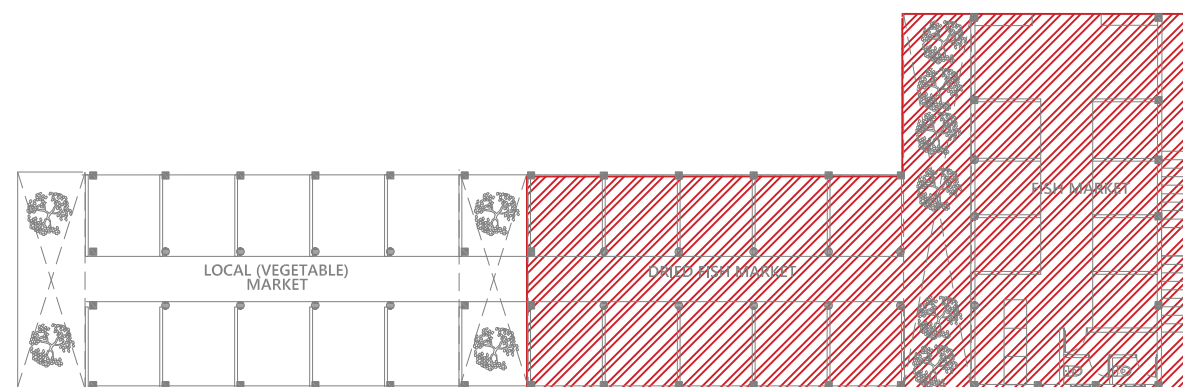
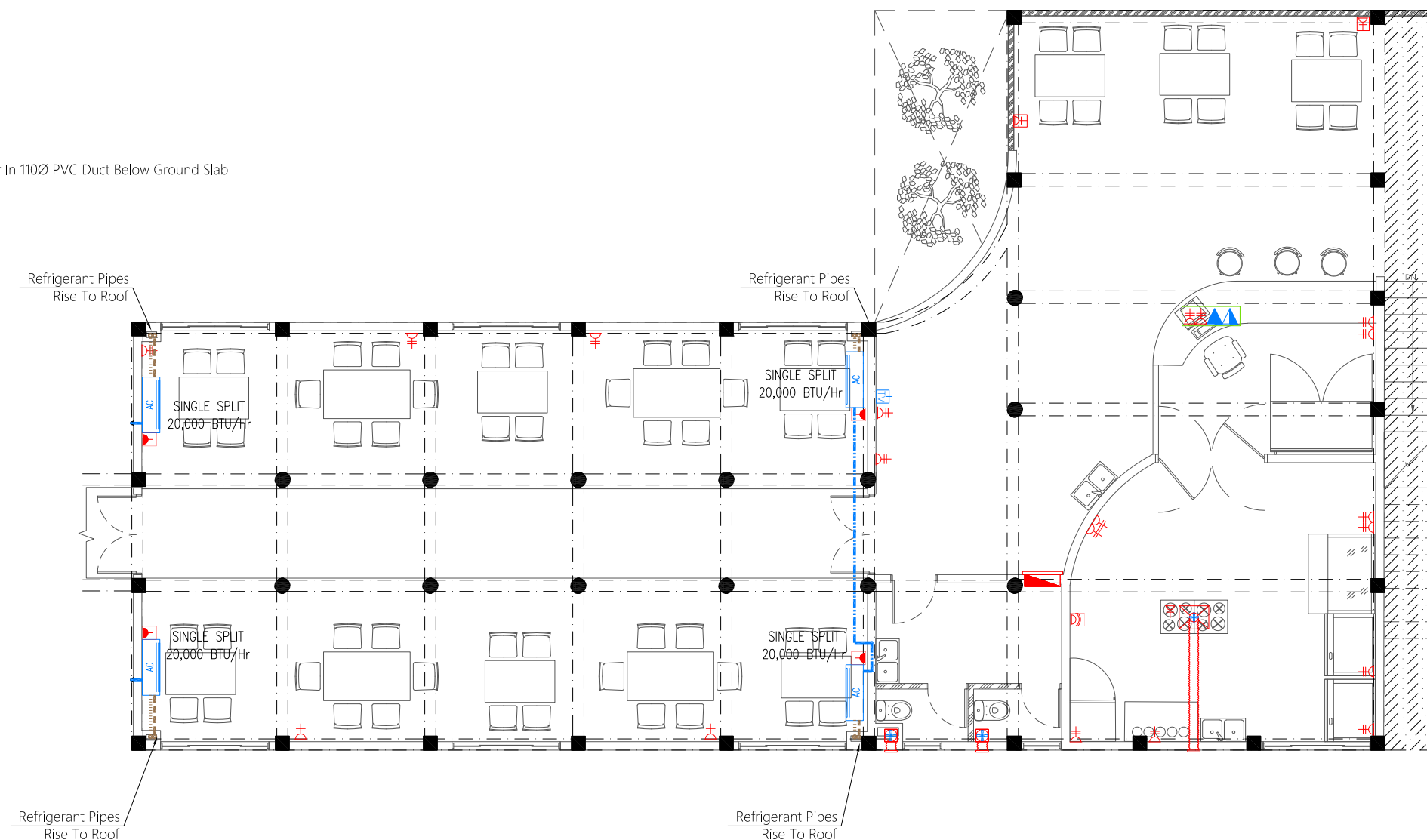

FIRST FLOOR POWER AND ACV LAYOUT-2

1:100

PROPOSED 02 STOREY BUILDING AT
**VILIMALE' FISH
MARKET**

Client:
**LOCAL GOVERNMENT
AUTHORITY**

November 2019

Services By: Mohamed Rassam
Checked By:
Drawn By: Hussain Rasheed



T: +960 333 3328 E: info@epochassociates
W: www.epochassociates A: M. Alagashchuge,
Fareedhee Magu Mulu' Republic of Maldives

Rev: ---

Page: ---
PAC-04

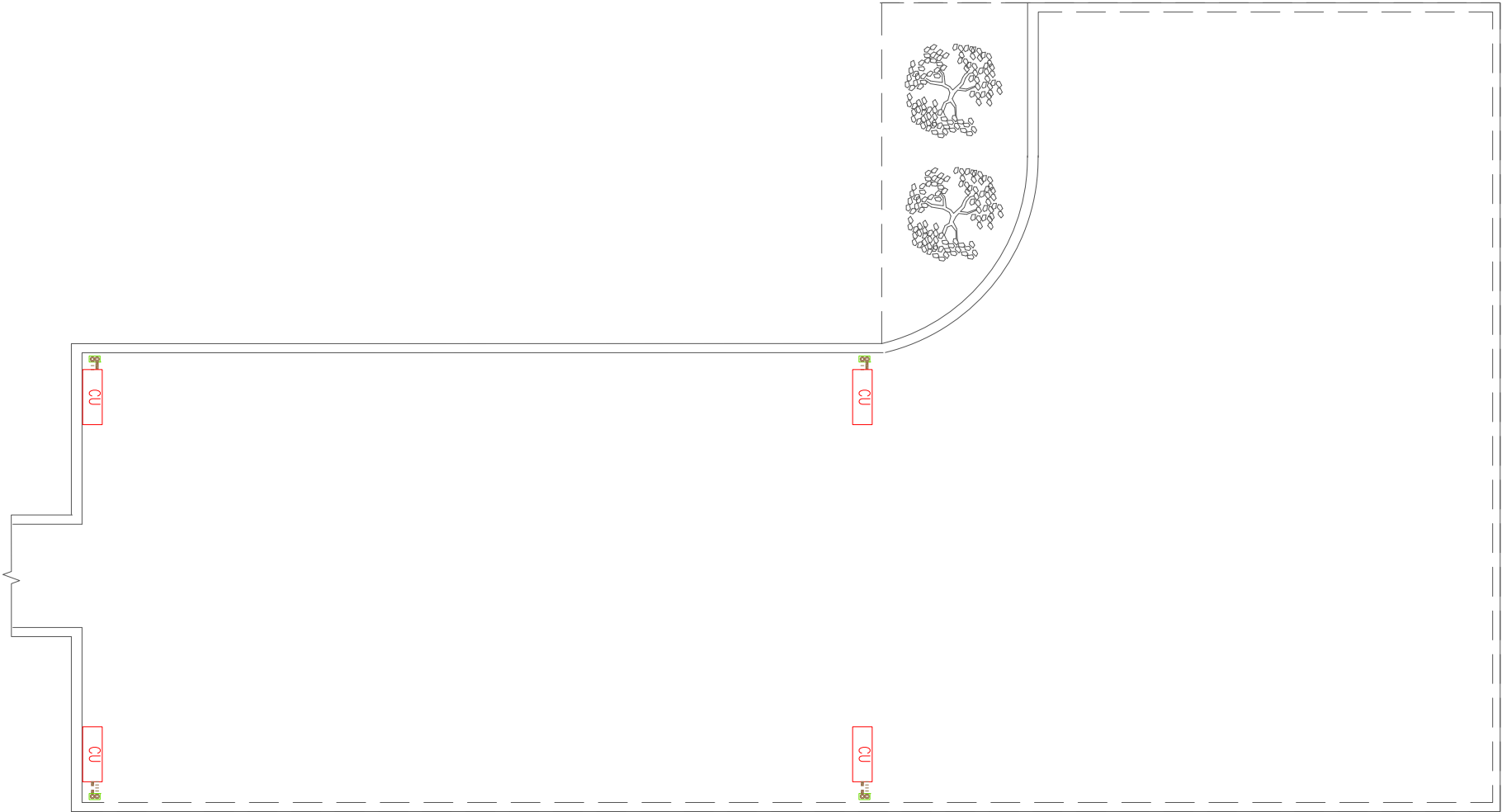
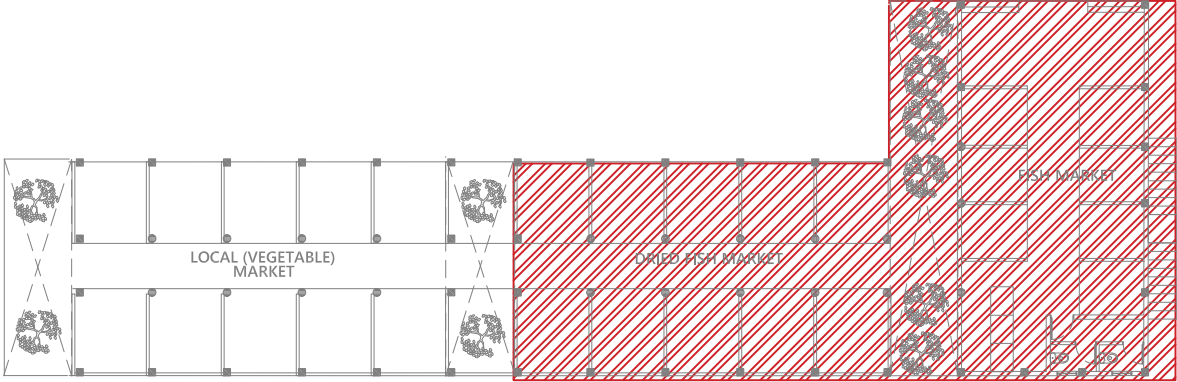

- Legend
- Refrigerant Pipes
 - 25Ø Condensate Drain Pipe
 - 40Ø Condensate Drain Riser Pipe
 - Kitchen Hood
 - Ceiling Mounted Exhaust Fan 90m3/hr
 - AC Wall Mount Air Conditioner
 - CU Outdoor Condensing Unit

ROOF POWER AND ACV LAYOUT-2

1:100

PROPOSED 02 STOREY BUILDING AT
VILIMALE' FISH MARKET

Client:
LOCAL GOVERNMENT AUTHORITY

November 2019

Services By: Mohamed Rassam
Checked By:
Drawn By: Hussain Rasheed

















T: +960 333 3528 | info@epoch.associates
W: www.epoch.associates, A. M. Abagadhooshege,
Fareedhee Magu, Male' Republic of Maldives

| Rev | Page |
|-----|------|
| --- | --- |
| --- | --- |
| --- | --- |

PAC-05

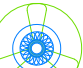
Legend

-  Ceiling Light (12W)
-  Recessed Ceiling Light (12W)
-  Ceiling Down Light (18W) - Weather Proof
-  50W LED Flood Light IP65
-  Pendant Light (12W)
-  Wall Light - Weather Proof Ip55 (low Level 8W)
-  Ceiling Recessed Spot Light (3W)
-  Weather Proof Wall Light IP55 (12W)
-  Light Switch (1 Gang - 4 Gang)
-  Ceiling Fan Switch With Controller
-  29" To 36" Ceiling Fan
-  42" To 48" Ceiling Fan
-  42" To 48" Ceiling Fan With Decorative Pendant
-  Ceiling Mounted Exhaust Fan 90m3/hr

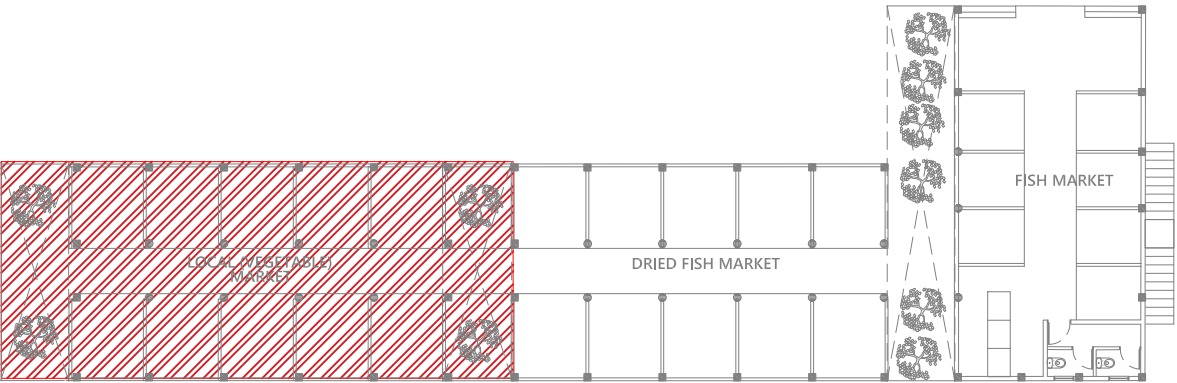
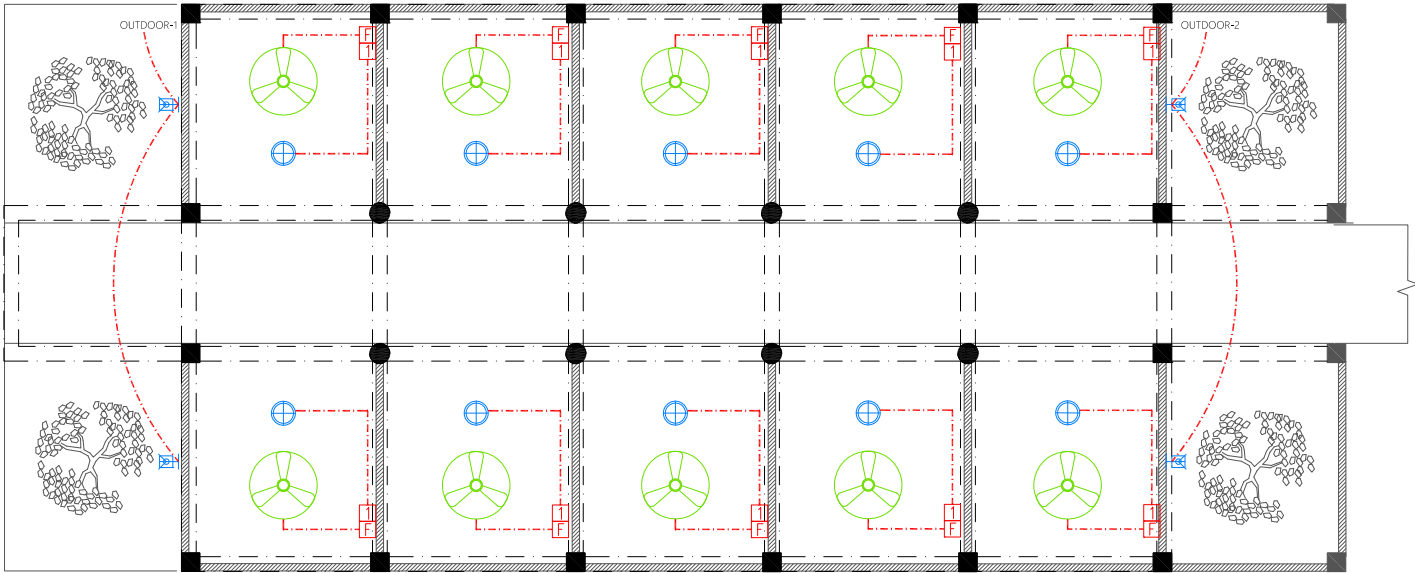

GROUND FLOOR LIGHTING AND FDP LAYOUT-1

1:100

PROPOSED 02 STOREY BUILDING AT
**VILIMALE' FISH
MARKET**

Client:
**LOCAL GOVERNMENT
AUTHORITY**

November 2019

Services By: Mohamed Rassam
Checked By:
Drawn By: Hussain Rasheed



T: +960 333 3528 | E: info@epoch.associates
W: www.epoch.associates | A. M. Abagandhoshuge,
Fareedhee Magu Male' Republic of Maldives

| Rev | Page |
|-----|-------|
| --- | EL-01 |

Legend

- ⊕ Ceiling Light (12W)
- ⊙ Recessed Ceiling Light (12W)
- ⊙ Ceiling Down Light (18W) - Weather Proof
- ☐ 50W LED Flood Light IP65
- ⊕ Pendant Light (12W)
- ☐ Wall Light - Weather Proof Ip55 (low Level 8W)
- ⊙ Ceiling Recessed Spot Light (3W)
- ☐ Weather Proof Wall Light IP55 (12W)
- 1 2 3 4 Light Switch (1 Gang - 4 Gang)
- F Ceiling Fan Switch With Controller
- 29" To 36" Ceiling Fan
- 42" To 48" Ceiling Fan
- 42" To 48" Ceiling Fan With Decorative Pendant
- ☐ Ceiling Mounted Exhaust Fan 90m3/hr

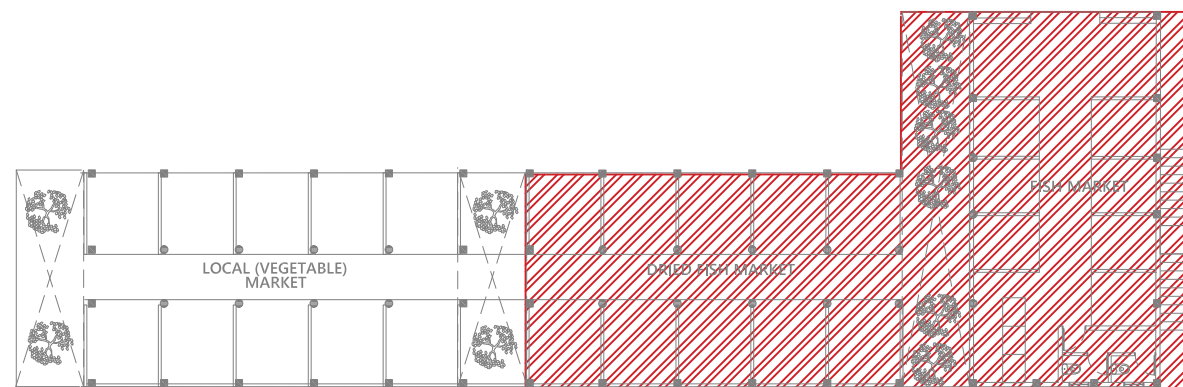
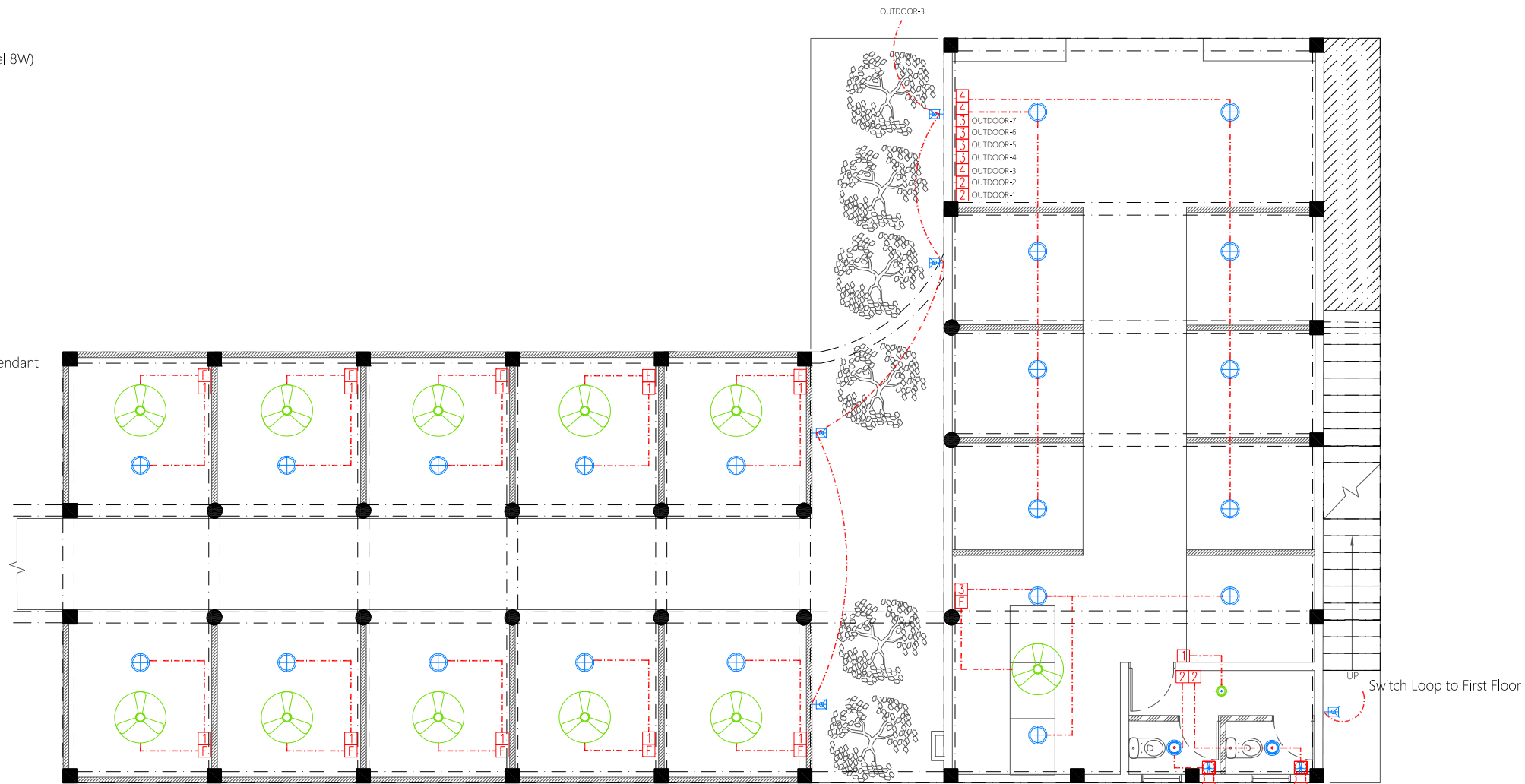

GROUND FLOOR LIGHTING AND FDP LAYOUT-2

PROPOSED 02 STOREY BUILDING AT
**VILIMALE' FISH
MARKET**

Client:
**LOCAL GOVERNMENT
AUTHORITY**

November 2019















Services By: Mohamed Rassam
Checked By:
Drawn By: Hussain Rasheed



T: +960 333 3528 | info@epoch.associates
W: www.epoch.associates | A. M. Abagandhooshege,
Fareeha Magu Male' Republic of Maldives

| Rev | Page |
|-----|-------|
| --- | EL-02 |

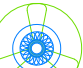
Legend

-  Ceiling Light (12W)
-  Recessed Ceiling Light (12W)
-  Ceiling Down Light (18W) - Weather Proof
-  50W LED Flood Light IP65
-  Pendant Light (12W)
-  Wall Light - Weather Proof Ip55 (low Level 8W)
-  Ceiling Recessed Spot Light (3W)
-  Weather Proof Wall Light IP55 (12W)
-  Light Switch (1 Gang - 4 Gang)
-  Ceiling Fan Switch With Controller
-  29" To 36" Ceiling Fan
-  42" To 48" Ceiling Fan
-  42" To 48" Ceiling Fan With Decorative Pendant
-  Ceiling Mounted Exhaust Fan 90m3/hr

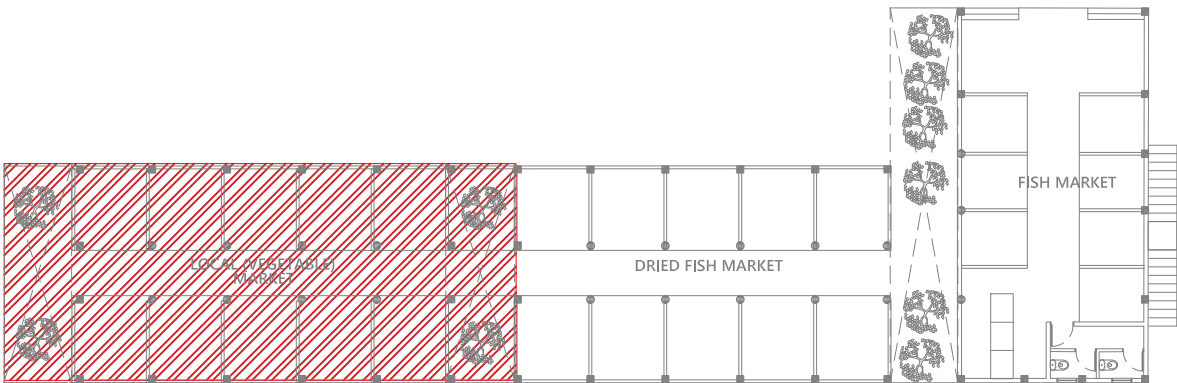
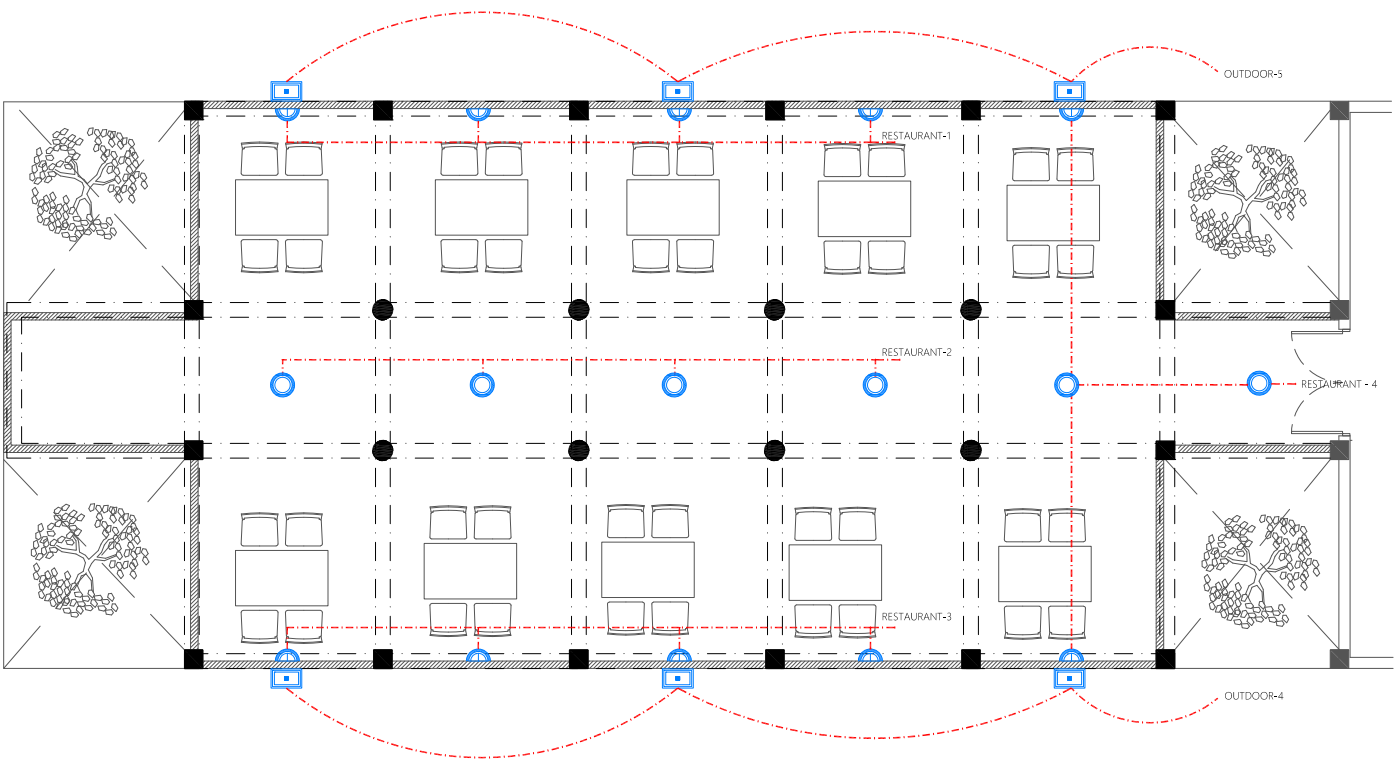

FIRST FLOOR LIGHTING AND FDP LAYOUT-1

1:100

PROPOSED 02 STOREY BUILDING AT
**VILIMALE' FISH
MARKET**

Client:
**LOCAL GOVERNMENT
AUTHORITY**

November 2019















Services By: Mohamed Rassam
Checked By:
Drawn By: Hussain Rasheed



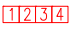

T: +960 333 3528 | E: info@epoch.associates
W: www.epoch.associates | A. M. Abagandhooshege,
Fareedhee Magu Male' Republic of Maldives

| Rev | Page |
|-----|-------|
| --- | EL-03 |
| --- | |
| --- | |

Legend

-  Ceiling Light (12W)
-  Recessed Ceiling Light (12W)
-  Ceiling Down Light (18W) - Weather Proof
-  50W LED Flood Light IP65
-  Pendant Light (12W)
-  Wall Light - Weather Proof Ip55 (low Level 8W)
-  Ceiling Recessed Spot Light (3W)
-  Weather Proof Wall Light IP55 (12W)
-  Light Switch (1 Gang - 4 Gang)
-  Ceiling Fan Switch With Controller
-  29" To 36" Ceiling Fan
-  42" To 48" Ceiling Fan
-  42" To 48" Ceiling Fan With Decorative Pendant
-  Ceiling Mounted Exhaust Fan 90m3/hr

Legend

-  CO₂ Extinguisher (load: 2kg) In Polycarbonate Enclosure
-  H₂O Extinguisher (load: 9L) In Polycarbonate Enclosure
-  Fire Blanket

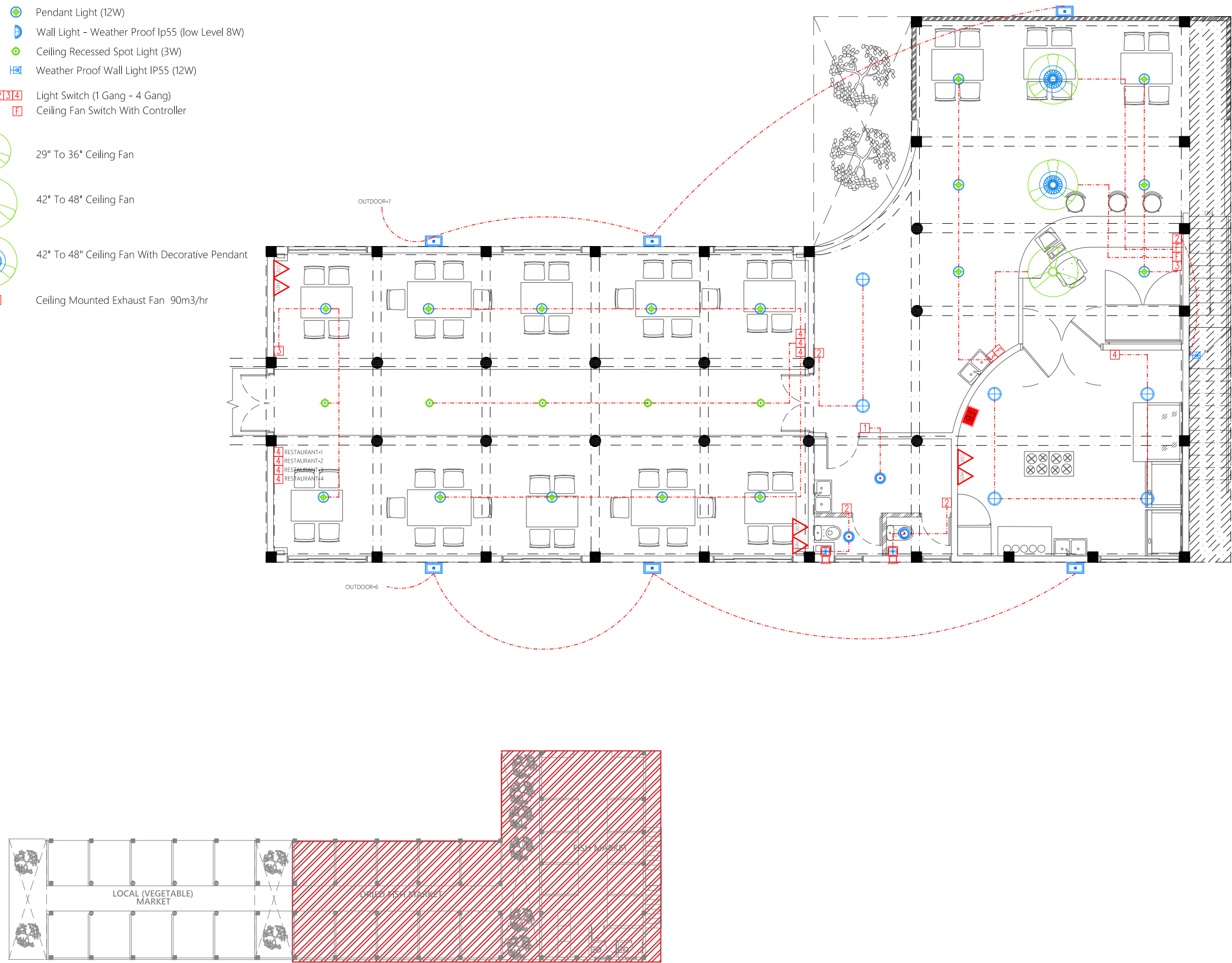

FIRST FLOOR LIGHTING AND FDP LAYOUT-2

1:100

PROPOSED 02 STOREY BUILDING AT
**VILIMALE' FISH
MARKET**

Client:
**LOCAL GOVERNMENT
AUTHORITY**

November 2019
Services By: Mohamed Rassam
Checked By:
Drawn By: Hussain Rasheed



T: +960 333 3528 | E: info@epoch.associates
W: www.epoch.associates | A. M. Abgasandhoshuge,
Fareeha Magu Male' Republic of Maldives

| Rev | Page |
|-----|-------|
| --- | EL-04 |

- Legend
- 16Ø Cold Water Supply To Basin Faucet
 - 16Ø Cold Water Supply To Sink Tap
 - 16Ø Cold Water Supply To Bidet Shower
 - 16Ø Cold Water Supply To Cistern
 - 16Ø Cold Water Supply To Wall Tap
 - Gate Valve
 - Rise In Wall
 - Drop In Wall
 - MWSC/FENAKA Meter
 - 20Ø Cold Water Supply Pipes Running Underground
 - 20Ø Cold Water Supply Pipes Running In Wall
 - 20Ø Cold Water Supply Pipes Running Above False Ceiling

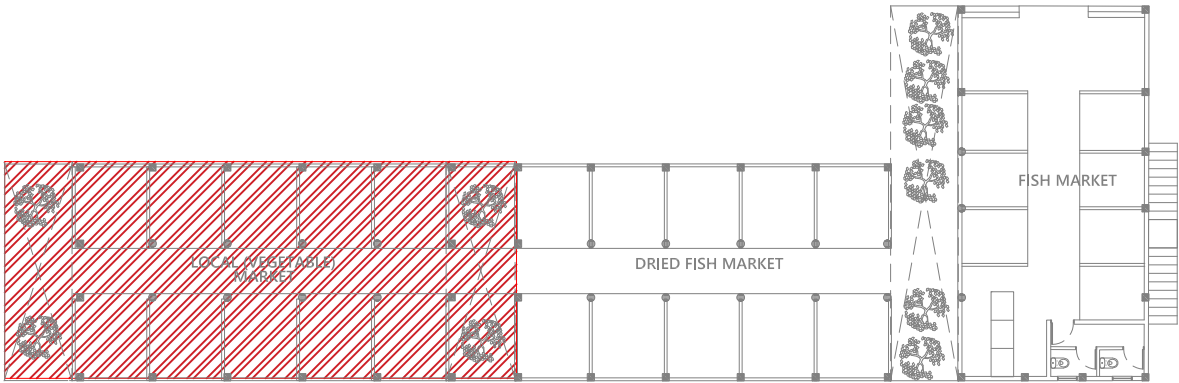
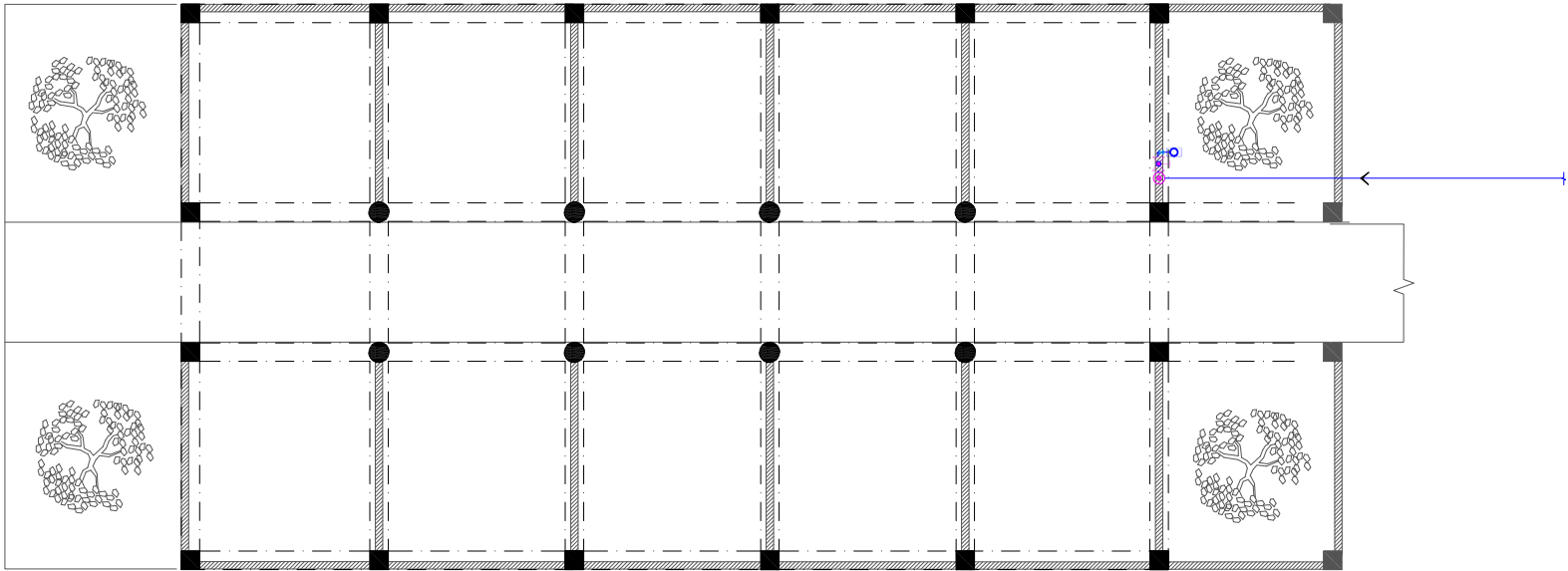

GROUND FLOOR PLUMBING LAYOUT-1

1:100

PROPOSED 02 STOREY BUILDING AT
VILIMALE' FISH MARKET

Client:
LOCAL GOVERNMENT AUTHORITY

November 2019

Services By: Mohamed Rassam
Checked By:
Drawn By: Hussain Rasheed

EPOCH ASSOCIATES

T: +960 333 3328 E: info@epochassociates
W: www.epochassociates A: M. Alagashihuge, Faridheer Magu Mulu' Republic of Maldives

| Rev. | Page: |
|------|-------|
| --- | --- |
| --- | --- |
| --- | --- |

PL-01

Legend

- 16Ø Cold Water Supply To Basin Faucet
- 16Ø Cold Water Supply To Sink Tap
- 16Ø Cold Water Supply To Bidet Shower
- 16Ø Cold Water Supply To Cistern
- 16Ø Cold Water Supply To Wall Tap
- Gate Valve
- Rise In Wall
- Drop In Wall
- MWSC/FENAKA Meter
- 20Ø Cold Water Supply Pipes Running Underground
- 20Ø Cold Water Supply Pipes Running In Wall
- 20Ø Cold Water Supply Pipes Running Above False Ceiling

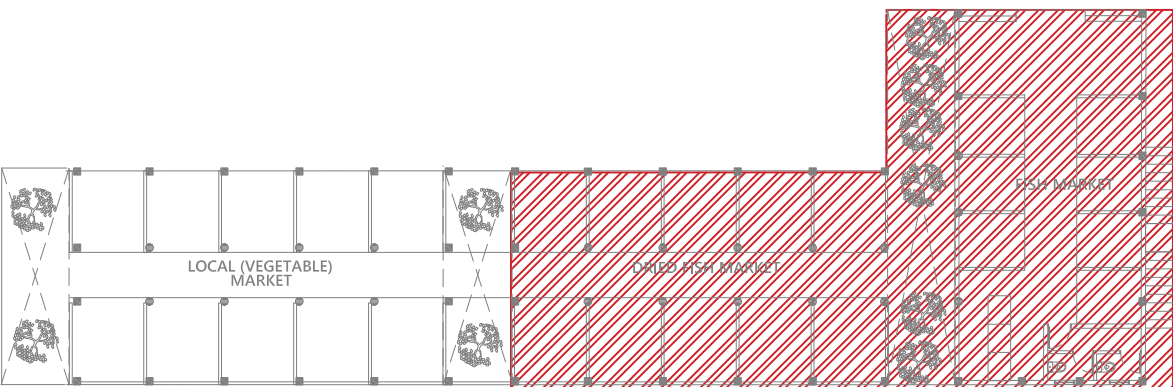
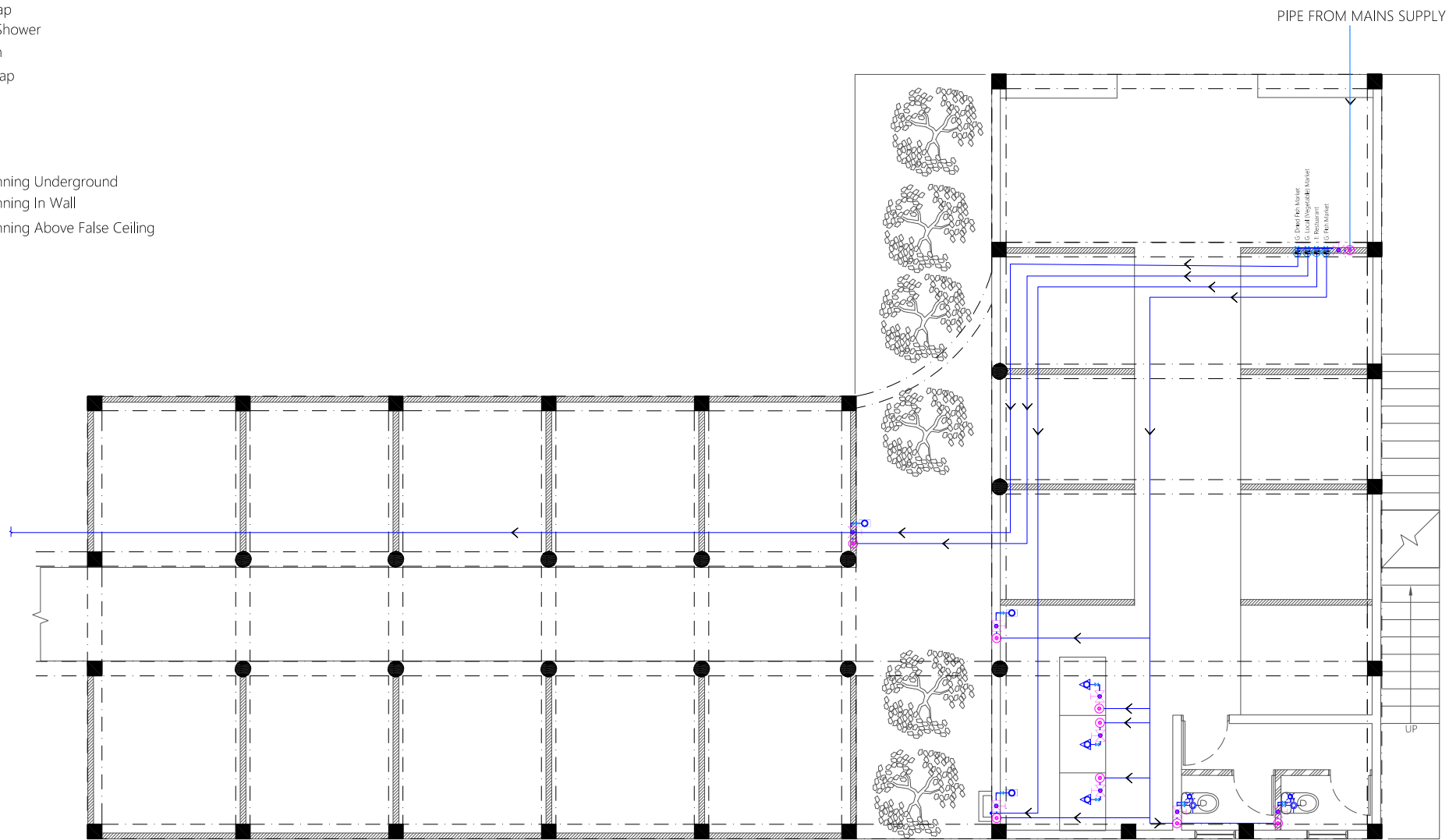

GROUND FLOOR PLUMBING LAYOUT-2

PROPOSED 02-STOREY BUILDING AT
**VILIMALE' FISH
MARKET**

Client:
**LOCAL GOVERNMENT
AUTHORITY**

November 2019

Services By: Mohamed Rassam
Checked By:
Drawn By: Hussain Rasheed



T: +960 333 3328 E: info@epochassociates
W: www.epochassociates A: M. Alagaddhoothuge,
Fareedhee Magu Male' Republic of Maldives

Rev: --- Page: ---
PL-01

Legend

- 16Ø Cold Water Supply To Basin Faucet
- 16Ø Cold Water Supply To Sink Tap
- 16Ø Cold Water Supply To Bidet Shower
- 16Ø Cold Water Supply To Cistern
- 16Ø Cold Water Supply To Wall Tap
- Gate Valve
- Rise In Wall
- Drop In Wall
- MWSC/FENAKA Meter
- 20Ø Cold Water Supply Pipes Running Underground
- 20Ø Cold Water Supply Pipes Running In Wall
- 20Ø Cold Water Supply Pipes Running Above False Ceiling

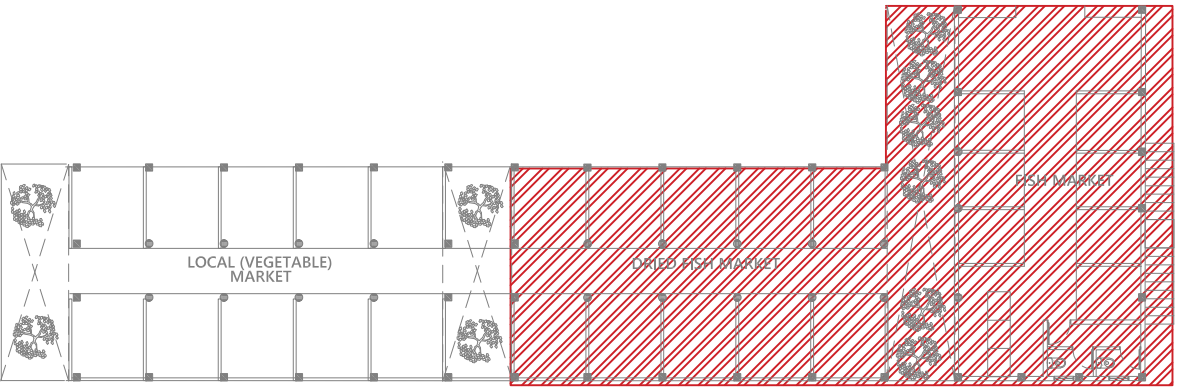
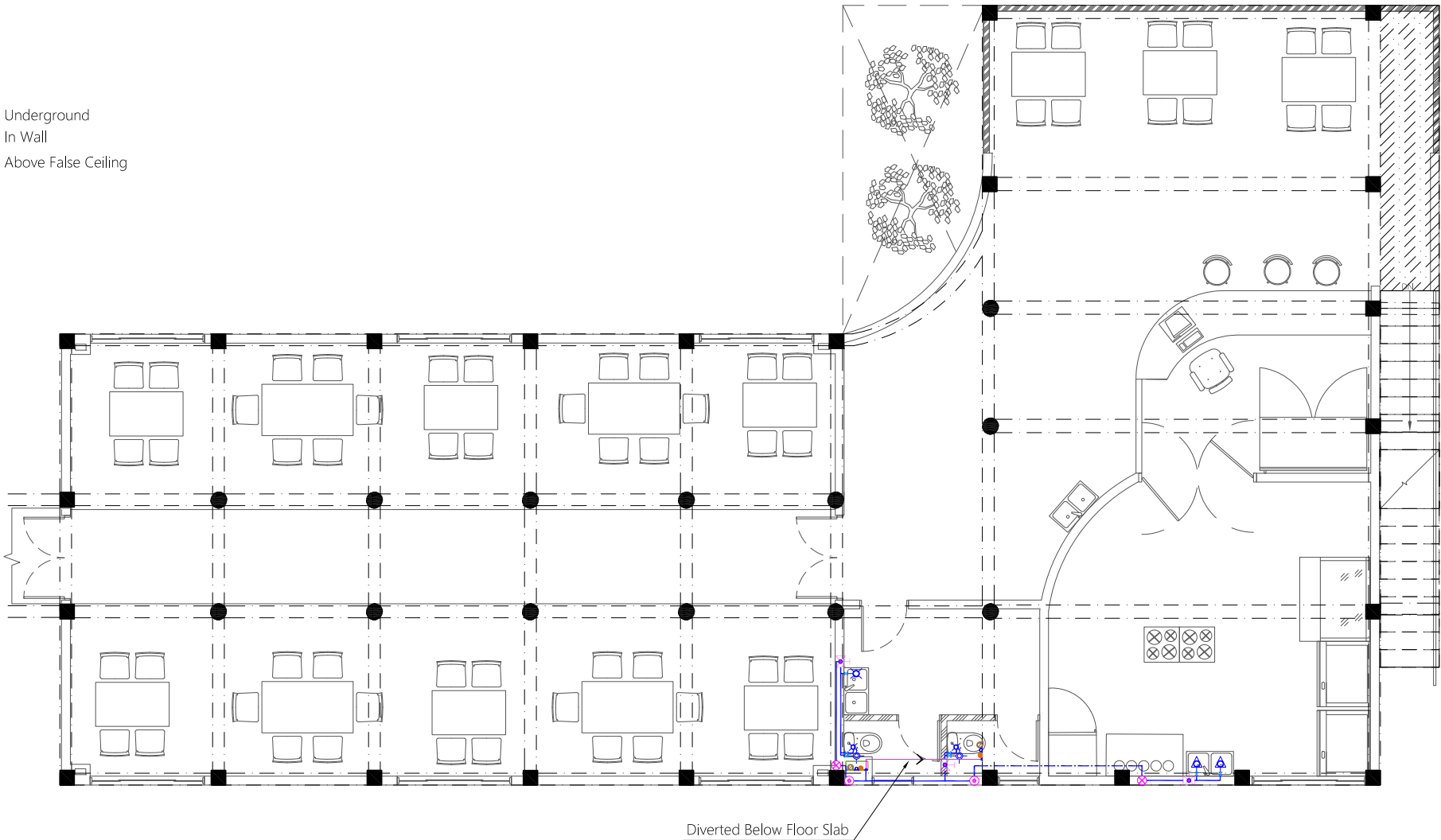

FIRST FLOOR PLUMBING LAYOUT-2

1:100

PROPOSED 02 STOREY BUILDING AT
**VILIMALE' FISH
MARKET**

Client:
**LOCAL GOVERNMENT
AUTHORITY**















November 2019
Services By: Mohamed Rassam
Checked By:
Drawn By: Hussain Rasheed



T: +960 333 3528 | info@epoch.associates
W: www.epoch.associates | A. M. Alagandhooshye,
Fareedhee Magu, Male' Republic of Maldives

| Rev | Page |
|-----|-------|
| --- | PL-02 |

Legend

-  Floor Drain
-  Floor Gully
-  82Ø Soil Pipe (uPVC Pipe)
-  82Ø Soil Vent Pipe (uPVC Pipe)
-  63Ø Waste Pipe (uPVC Pipe)
-  63Ø Waste Vent Pipe (uPVC Pipe)
-  40Ø Waste Pipe (uPVC Pipe)
-  50Ø Manhole Vent Pipe (uPVC Pipe)
-  110Rain Water Pipes (uPVC Pipe)
-  Manhole
-  Gully Trap
-  110Ø Rainwater Outlet Perforated Cowl
-  Rodding Eye
-  Bottle Trap
-  Bottle Trap For Sink

Notes: -

- All Drainage Pipes Should Have At A Slope Of 1/150
- All Floor Drains Should Have 'P' Traps

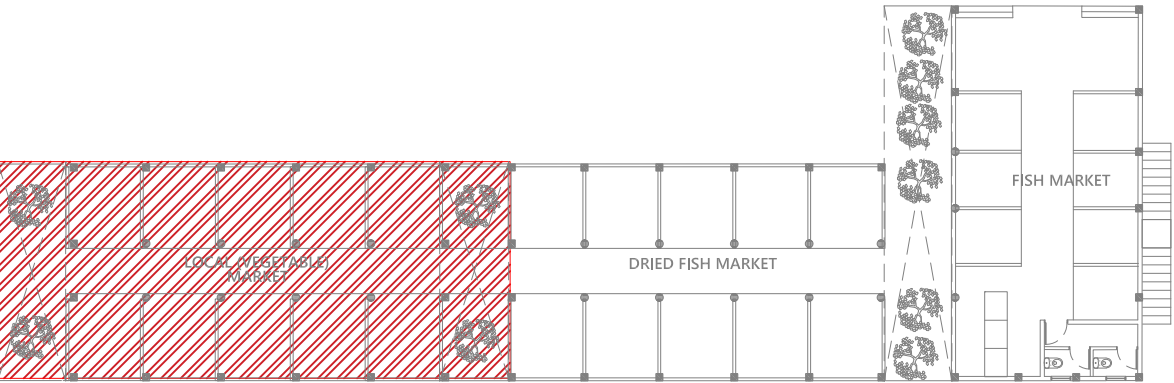
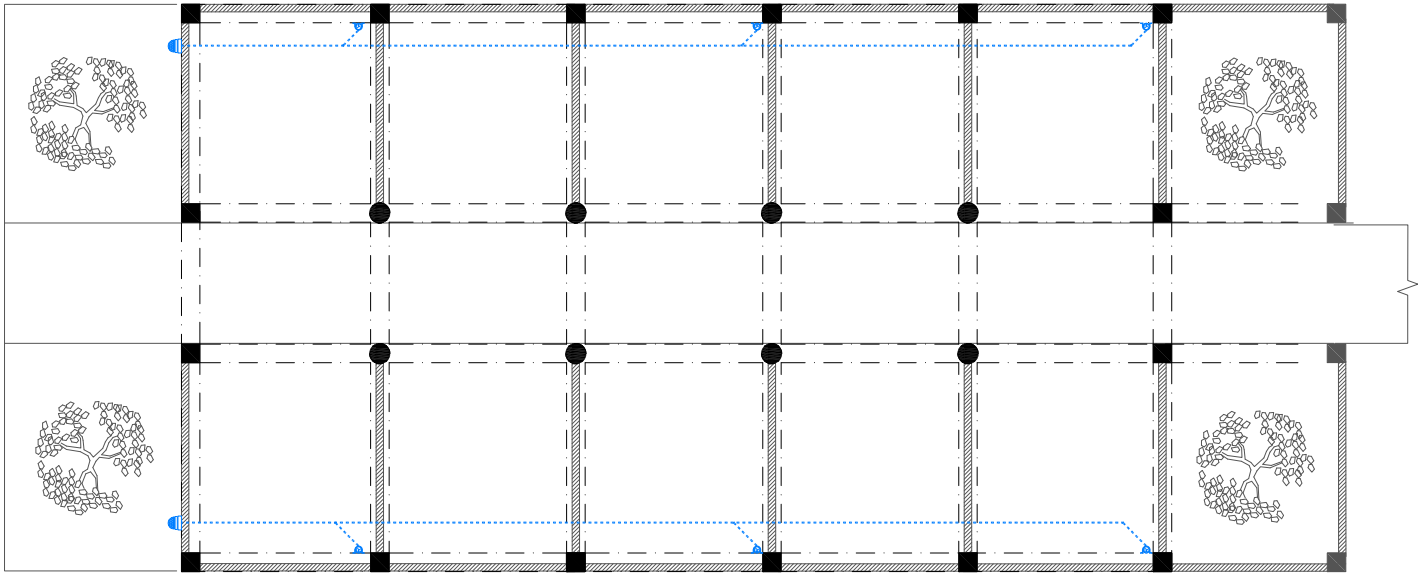

GROUND FLOOR DRAINAGE LAYOUT-1

1:100

PROPOSED 02 STOREY BUILDING AT
**VILIMALE' FISH
MARKET**

Client:
**LOCAL GOVERNMENT
AUTHORITY**

November 2019

Services By: Mohamed Rassam
Checked By:
Drawn By: Hussain Rasheed



T: +960 333 3528 | E: info@epoch.associates
W: www.epoch.associates | A. M. Abagadhooshege,
Fareedhee Magu Male' Republic of Maldives

| Rev | Page |
|-----|------|
| --- | --- |
| --- | --- |
| --- | --- |

DR-01

- Legend
- Floor Drain
 - Floor Gully
 - 82Ø Soil Pipe (uPVC Pipe)
 - 82Ø Soil Vent Pipe (uPVC Pipe)
 - 63Ø Waste Pipe (uPVC Pipe)
 - 63Ø Waste Vent Pipe (uPVC Pipe)
 - 40Ø Waste Pipe (uPVC Pipe)
 - 50Ø Manhole Vent Pipe (uPVC Pipe)
 - 110Rain Water Pipes (uPVC Pipe)
 - Manhole
 - Gully Trap
 - 110Ø Rainwater Outlet Perforated Cowl
 - Rodding Eye
 - Bottle Trap
 - Bottle Trap For Sink

Notes: -

- All Drainage Pipes Should Have At A Slope Of 1/150
- All Floor Drains Should Have 'P' Traps

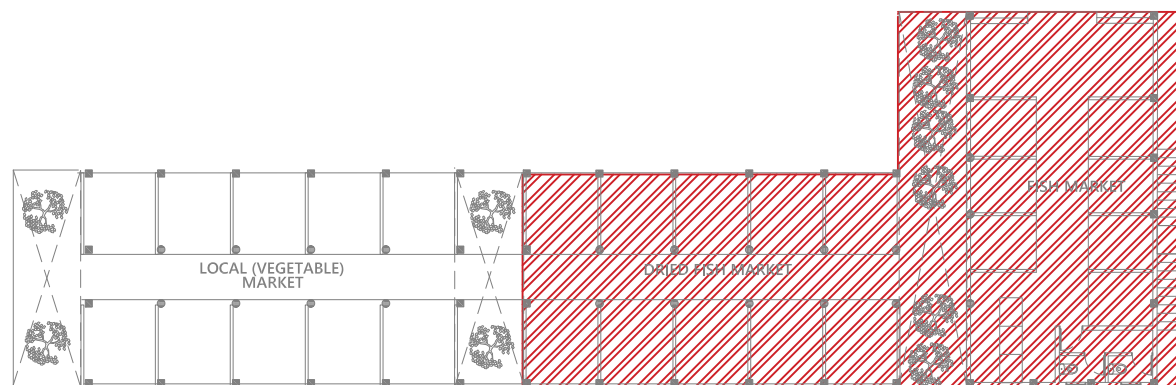
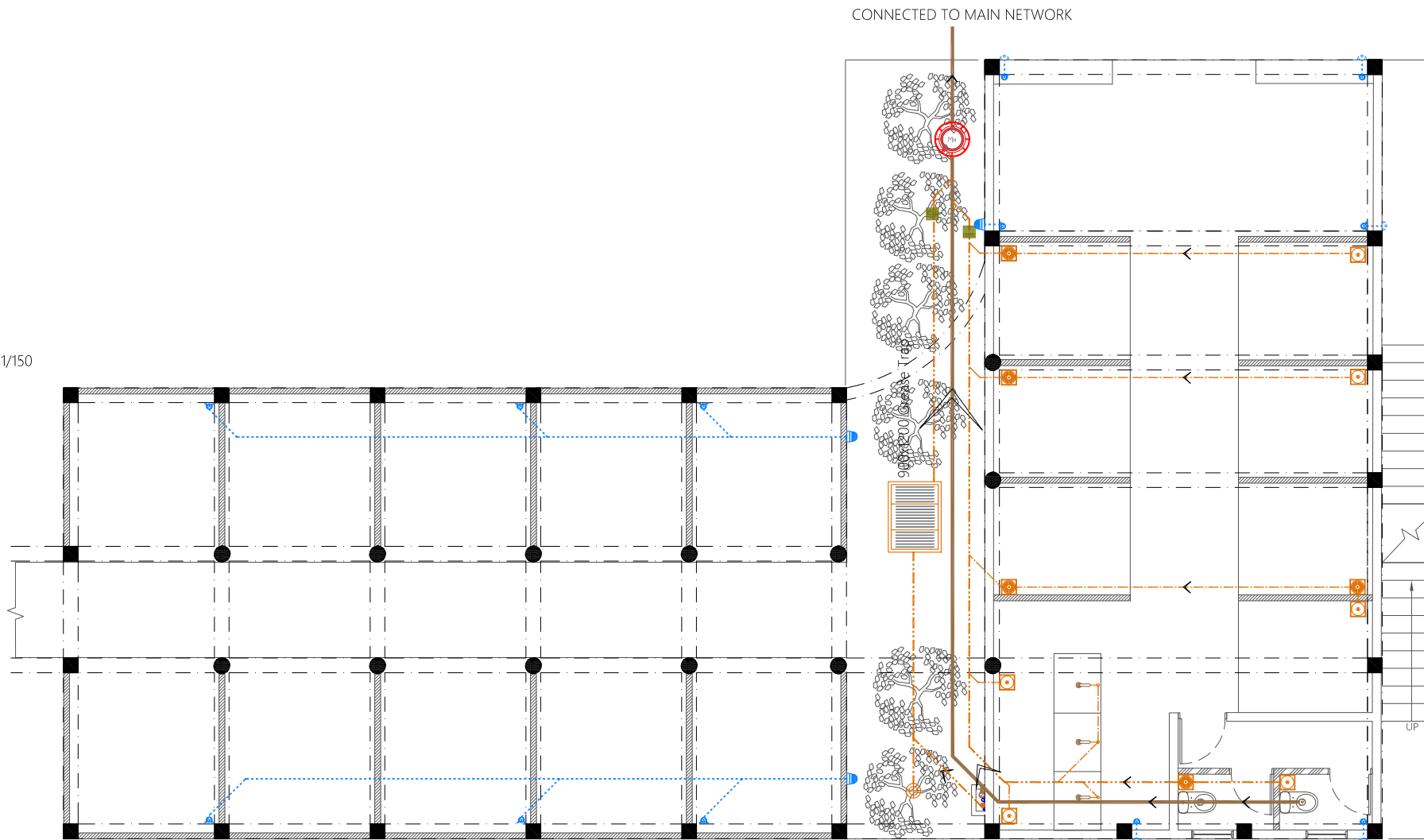

GROUND FLOOR DRAINAGE LAYOUT-2

PROPOSED 02 STOREY BUILDING AT
**VILIMALE' FISH
MARKET**

Client:
**LOCAL GOVERNMENT
AUTHORITY**

November 2019

Services By: Mohamed Rassam
Checked By:
Drawn By: Hussain Rasheed

















T: +960 333 3528 | info@epoch.associates
W: www.epoch.associates | A. M. Abagadhooshege,
Fareedhee Magu Male' Republic of Maldives

| Rev | Page |
|-----|------|
| --- | --- |
| --- | --- |
| --- | --- |

DR-02

Legend

-  Floor Drain
-  Floor Gully
-  82Ø Soil Pipe (uPVC Pipe)
-  82Ø Soil Vent Pipe (uPVC Pipe)
-  63Ø Waste Pipe (uPVC Pipe)
-  63Ø Waste Vent Pipe (uPVC Pipe)
-  40Ø Waste Pipe (uPVC Pipe)
-  50Ø Manhole Vent Pipe (uPVC Pipe)
-  110Rain Water Pipes (uPVC Pipe)
-  Manhole
-  Gully Trap
-  110Ø Rainwater Outlet Perforated Cowl
-  Rodding Eye
-  Bottle Trap
-  Bottle Trap For Sink

Notes: -

- All Drainage Pipes Should Have At A Slope Of 1/150
- All Floor Drains Should Have 'P' Traps

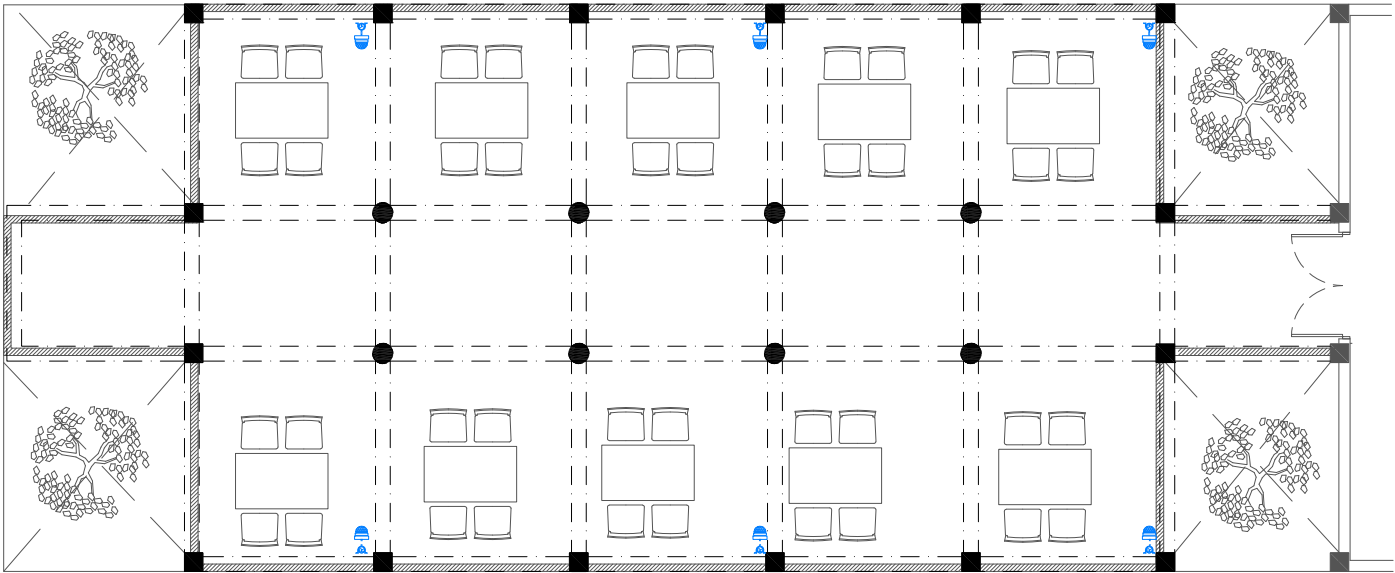

FIRST FLOOR DRAINAGE LAYOUT-1

1:100

PROPOSED 02 STOREY BUILDING AT
VILIMALE' FISH
MARKET

Client:
LOCAL GOVERNMENT
AUTHORITY

November 2019















Services By: Mohamed Rassam
Checked By:
Drawn By: Hussain Rasheed



T: +960 333 3528 | E: info@epoch.associates
W: www.epoch.associates | A. M. Abagadhooshaige,
Fareedhee Magu Male' Republic of Maldives

| Rev | Page |
|-----|-------|
| --- | DR-03 |
| --- | |
| --- | |

Legend

-  Floor Drain
-  Floor Gully
-  82Ø Soil Pipe (uPVC Pipe)
-  82Ø Soil Vent Pipe (uPVC Pipe)
-  63Ø Waste Pipe (uPVC Pipe)
-  63Ø Waste Vent Pipe (uPVC Pipe)
-  40Ø Waste Pipe (uPVC Pipe)
-  50Ø Manhole Vent Pipe (uPVC Pipe)
-  110Rain Water Pipes (uPVC Pipe)
-  Manhole
-  Gully Trap
-  110Ø Rainwater Outlet Perforated Cowl
-  Rodding Eye
-  Bottle Trap
-  Bottle Trap For Sink

Notes: -

- All Drainage Pipes Should Have At A Slope Of 1/150
- All Floor Drains Should Have 'P' Traps

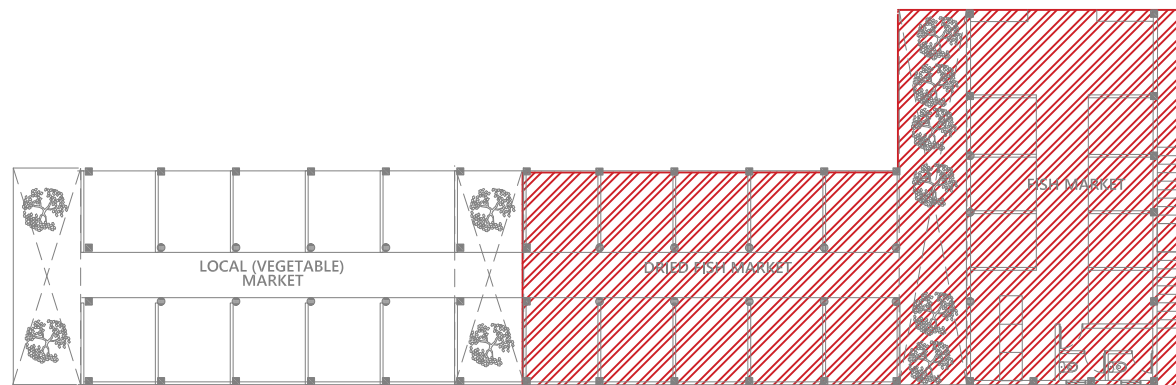
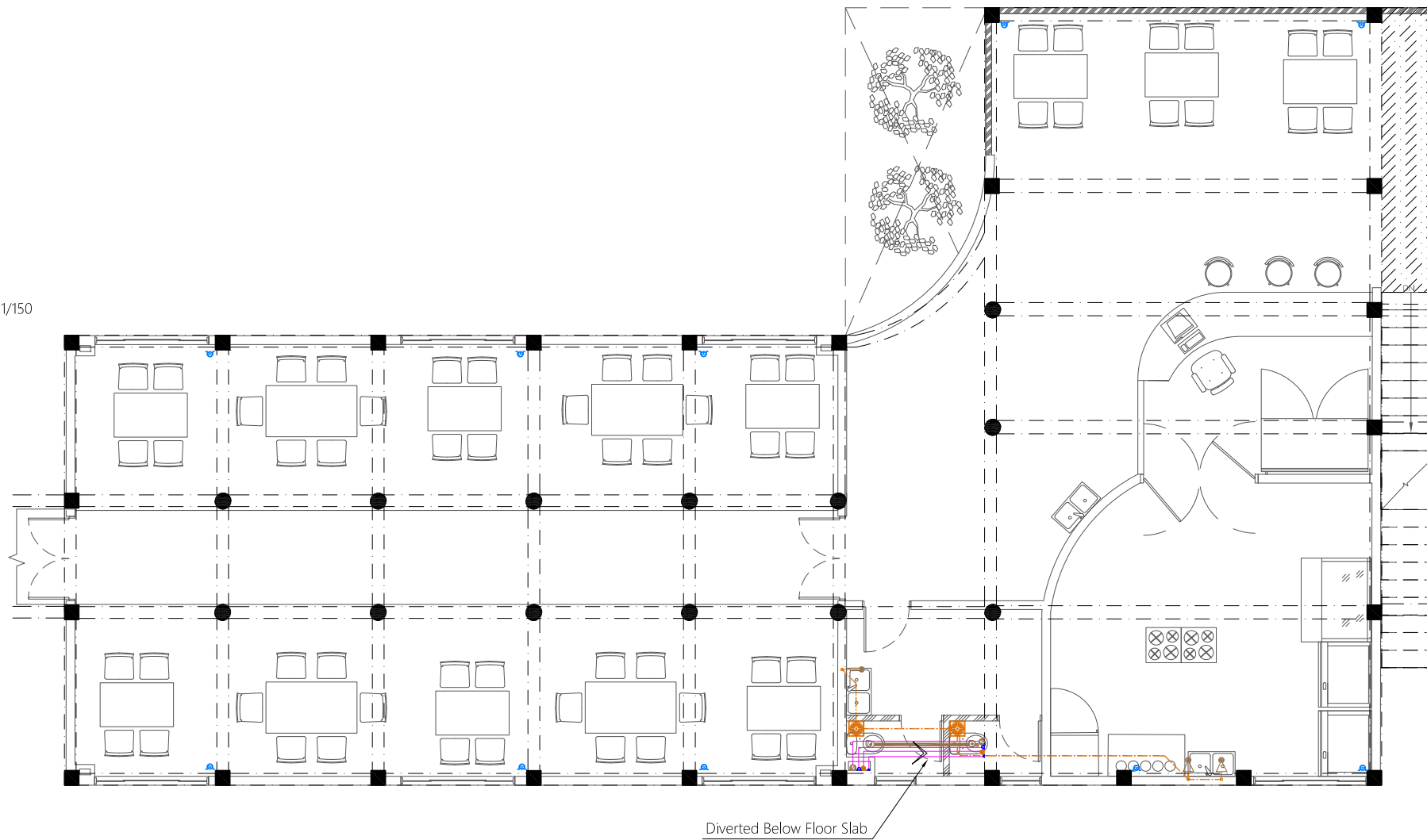

FIRST FLOOR DRAINAGE LAYOUT-2

1:100

PROPOSED 02 STOREY BUILDING AT
**VILIMALA' FISH
MARKET**

Client:
**LOCAL GOVERNMENT
AUTHORITY**

November 2019

Services By: Mohamed Rassam
Checked By:
Drawn By: Hussain Rasheed















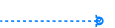

T: +960 333 3528 | E: info@epoch.associates
W: www.epoch.associates | A. M. Alagandhooshe,
Fareeha Magu, Male' Republic of Maldives

| | |
|------|-------|
| Rev: | Page: |
| --- | --- |
| --- | --- |
| --- | --- |

DR-04

Legend

-  Floor Drain
-  Floor Gully
-  82Ø Soil Pipe (uPVC Pipe)
-  82Ø Soil Vent Pipe (uPVC Pipe)
-  63Ø Waste Pipe (uPVC Pipe)
-  63Ø Waste Vent Pipe (uPVC Pipe)
-  40Ø Waste Pipe (uPVC Pipe)
-  50Ø Manhole Vent Pipe (uPVC Pipe)
-  110Rain Water Pipes (uPVC Pipe)
-  Manhole
-  Gully Trap
-  110Ø Rainwater Outlet Perforated Cowl
-  110Ø Rainwater Outlet
-  Rodding Eye
-  Bottle Trap
-  Bottle Trap For Sink

Notes: -

- All Drainage Pipes Should Have At A Slope Of 1/150
- All Floor Drains Should Have 'P' Traps

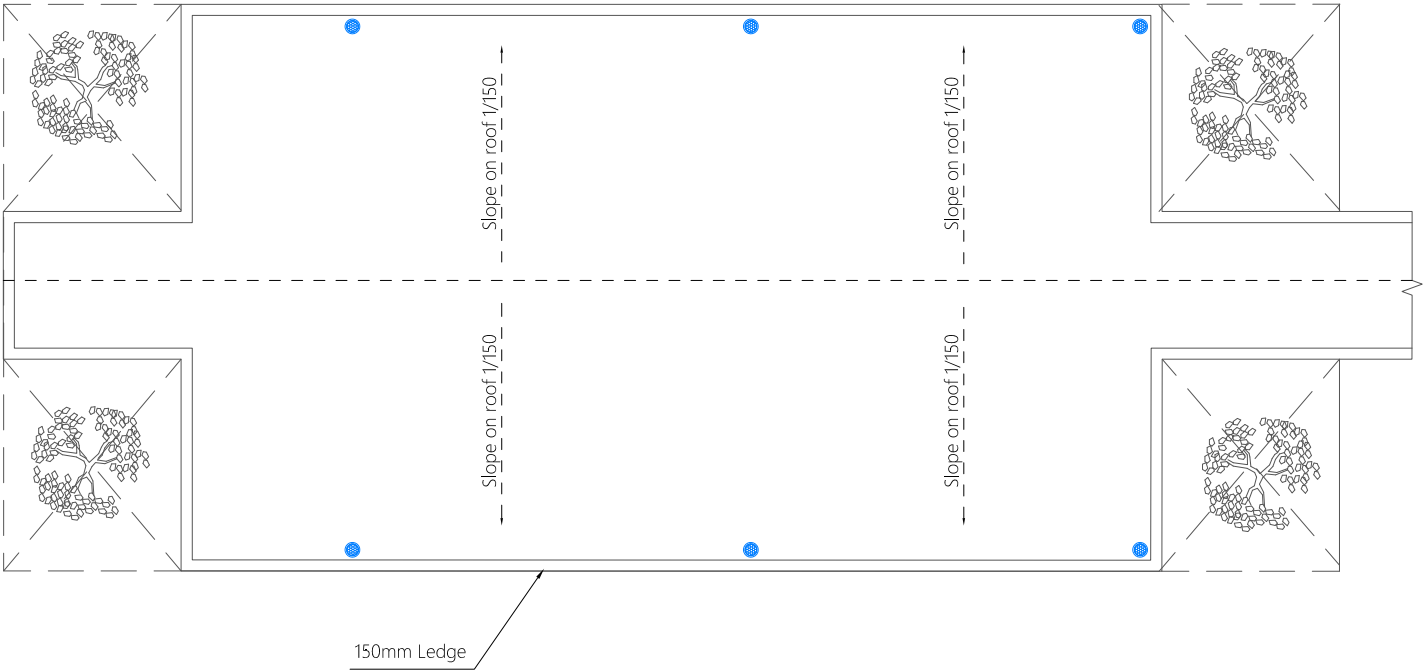

ROOF DRAINAGE LAYOUT-1

1:100

PROPOSED 02 STOREY BUILDING AT
**VILIMALE' FISH
MARKET**

Client:
**LOCAL GOVERNMENT
AUTHORITY**

November 2019

















Services By: Mohamed Rassam
Checked By:
Drawn By: Hussain Rasheed



T: +960 333 3528 | E: info@epoch.associates
W: www.epoch.associates | A. M. Abgasadhoshye,
Fareedhee Magu Male' Republic of Maldives

| Rev | Page |
|-----|-------|
| --- | DR-05 |
| --- | |
| --- | |

Legend

-  Floor Drain
-  Floor Gully
-  82Ø Soil Pipe (uPVC Pipe)
-  82Ø Soil Vent Pipe (uPVC Pipe)
-  63Ø Waste Pipe (uPVC Pipe)
-  63Ø Waste Vent Pipe (uPVC Pipe)
-  40Ø Waste Pipe (uPVC Pipe)
-  50Ø Manhole Vent Pipe (uPVC Pipe)
-  110Rain Water Pipes (uPVC Pipe)
-  Manhole
-  Gully Trap
-  110Ø Rainwater Outlet Perforated Cowl
-  110Ø Rainwater Outlet
-  Rodding Eye
-  Bottle Trap
-  Bottle Trap For Sink

Notes: -

- All Drainage Pipes Should Have At A Slope Of 1/150
- All Floor Drains Should Have 'P' Traps

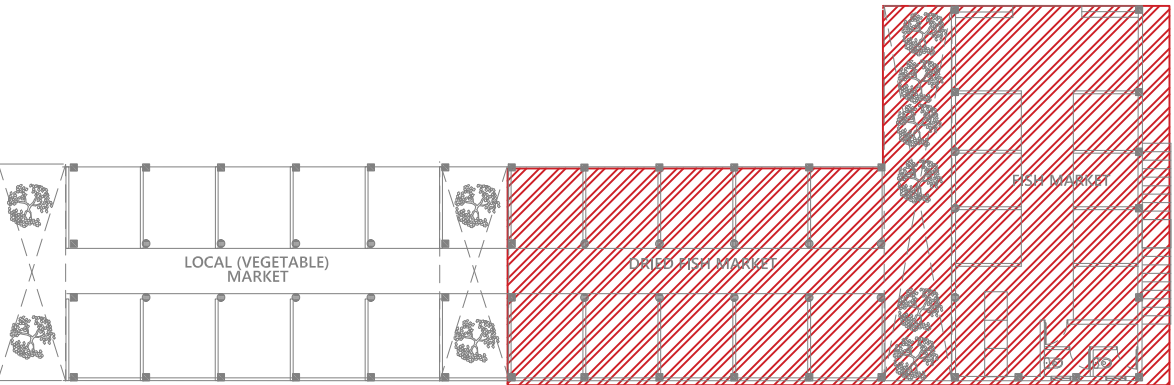

ROOF DRAINAGE LAYOUT-2

1:100

PROPOSED 02 STOREY BUILDING AT
**VILIMALE' FISH
MARKET**

Client:
**LOCAL GOVERNMENT
AUTHORITY**

November 2019

Services By: **Mohamed Rassam**
Checked By:
Drawn By: **Hussain Rasheed**



T: +960 333 3528 | E: info@epoch.associates
W: www.epoch.associates | A. M. Abagadhoshuge,
Fareedhee Magu, Male' Republic of Maldives

| Rev | Page |
|-----|------|
| --- | --- |
| --- | --- |
| --- | --- |

DR-06