

QUAY WALL UNIT

1 : 50

PROJECT:
CONSTRUCTION OF
L. FONADHOO HARBOUR

CONTENTS:
Quay Wall Corner
Block Details

DRAWING NO.:
001

SCALE:
NTS

DATE:
24 FEBRUARY 2017

ENGINEERING DIVISION
MINISTRY OF HOUSING AND INFRASTRUCTURE
REPUBLIC OF MALDIVES
TEL: 300 4300, FAX: 300 4301

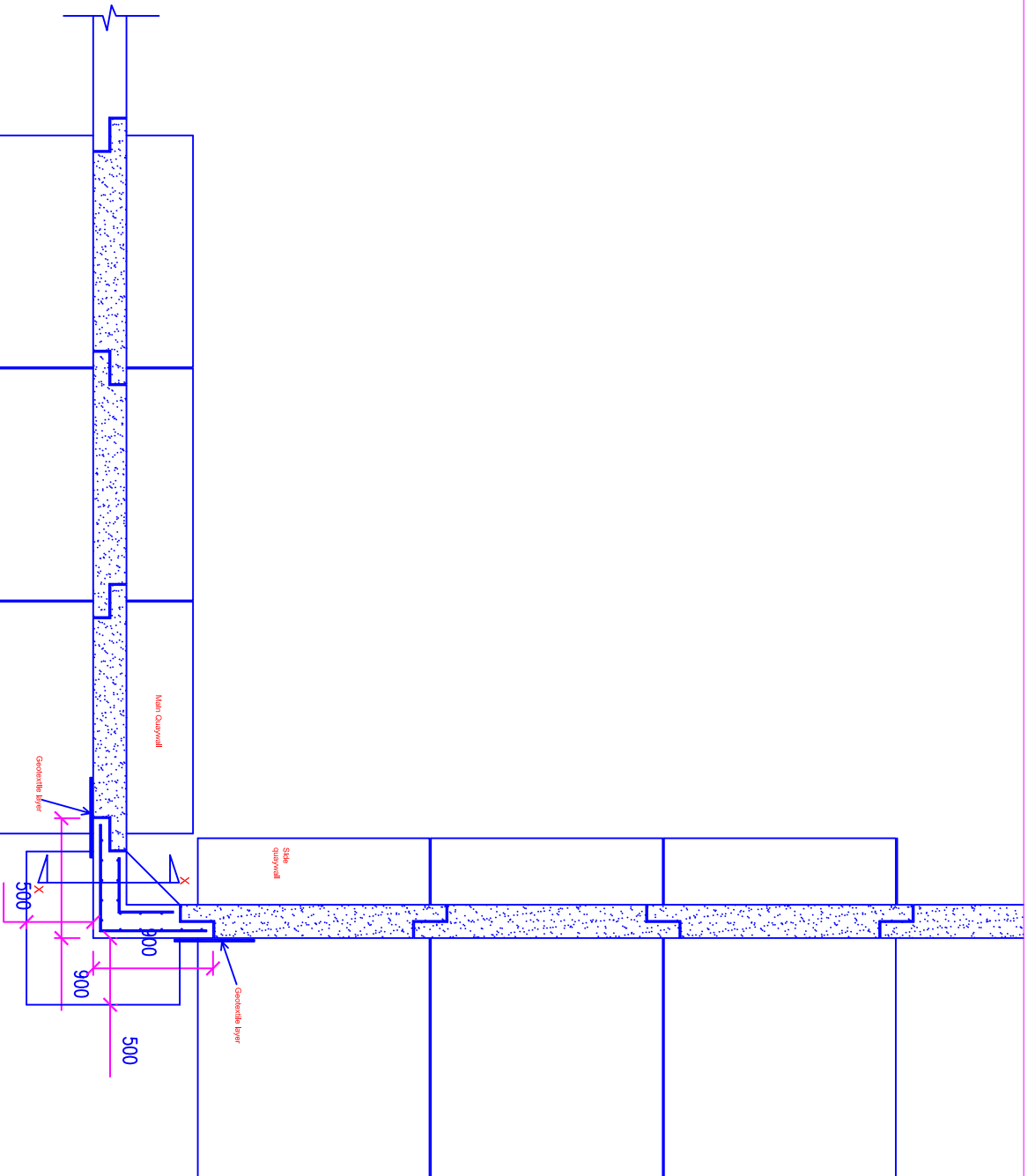

PROJECT:
**CONSTRUCTION OF
L. FONADHOO HARBOUR**

CONTENTS:
**Quay Wall Corner
Block Details**

DRAWING NO.:
002

SCALE:
NTS

DATE:
24 FEBRUARY 2017



**ENGINEERING DIVISION
MINISTRY OF HOUSING AND INFRASTRUCTURE
REPUBLIC OF MALDIVES
AMFENE MAGU, MALE 20392
TEL: 300 4300, FAX: 300 4301**

PROJECT: CONSTRUCTION OF L. FONADHOO HARBOUR	CONTENTS: Quay Wall Interlocking of Blocks	DRAWING NO.: 003	SCALE: NTS	DATE: 24 FEBRUARY 2017	ENGINEERING DIVISION MINISTRY OF HOUSING AND INFRASTRUCTURE MALE 20392 REPUBLIC OF MALDIVES TEL: 300 4300, FAX: 300 4301
--	--	---------------------	---------------	---------------------------	--

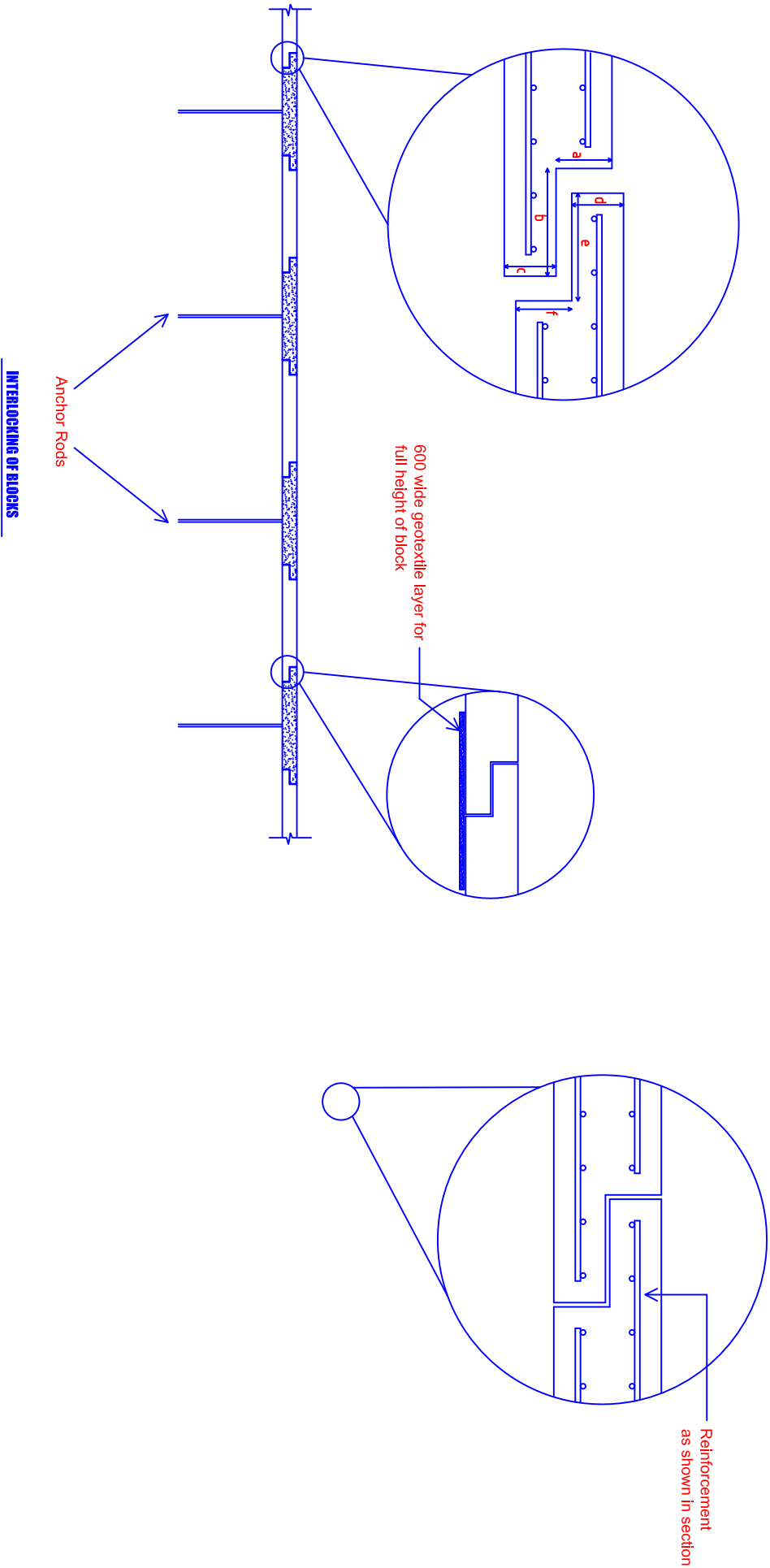

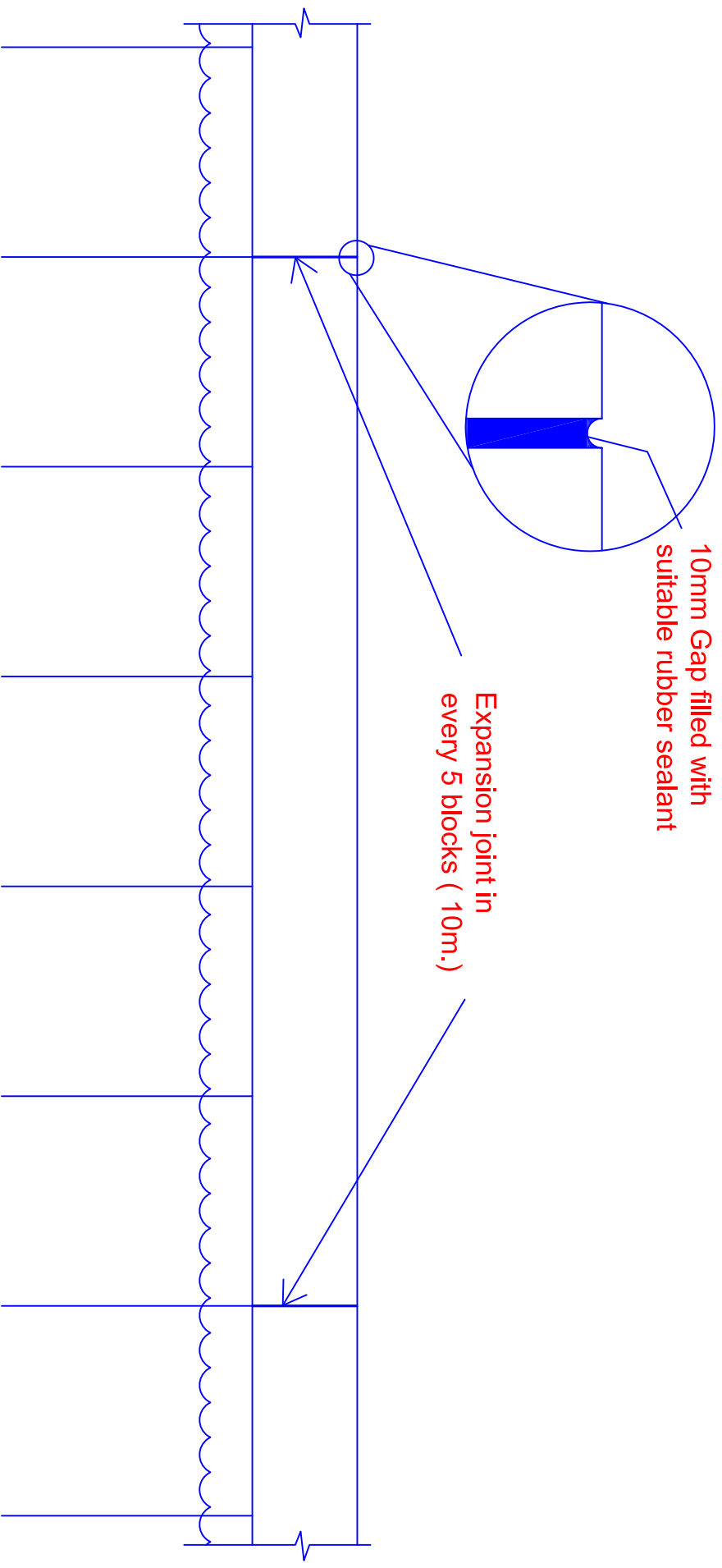

PROJECT:
CONSTRUCTION OF
L. FONADHOO HARBOUR

CONTENTS:
Quay Wall Expansion
Gap Detail

DRAWING NO.:
006

SCALE:
NTS

DATE:
24 FEBRUARY 2017



ENGINEERING DIVISION
MINISTRY OF HOUSING AND INFRASTRUCTURE
REPUBLIC OF MALDIVES
TEL: 300 4300, FAX: 300 4301

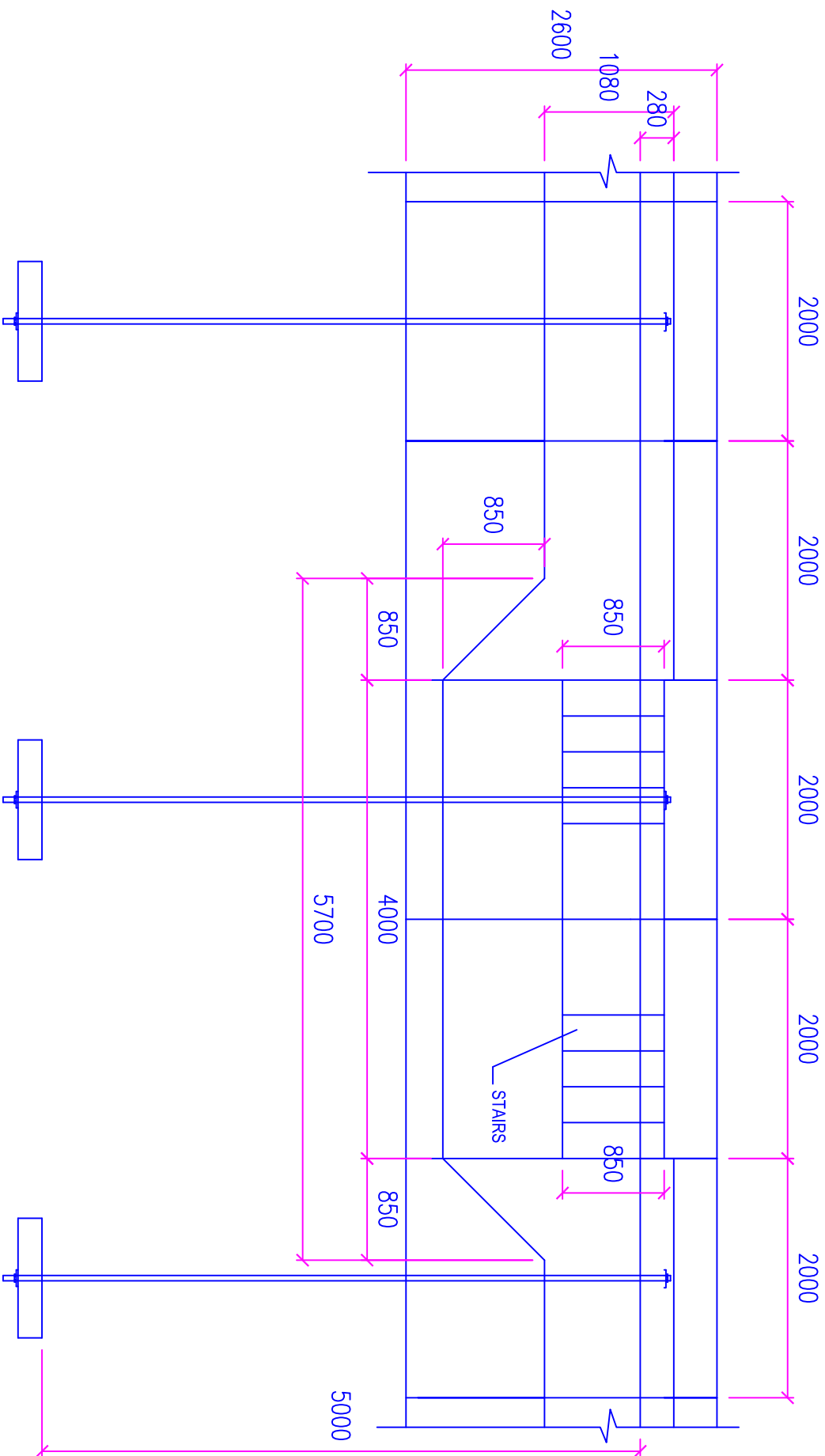

QUAY WALL & STAIRCASE PLAN

PROJECT:
CONSTRUCTION OF
L. FONADHOO HARBOUR

CONTENTS:
Quaywall Staircase
Plan

DRAWING NO.:
007

SCALE:
NTS

DATE:
24 FEBRUARY 2017

ENGINEERING DIVISION
MINISTRY OF HOUSING AND INFRASTRUCTURE
REPUBLIC OF MALDIVES
TEL: 300 4300, FAX: 300 4301

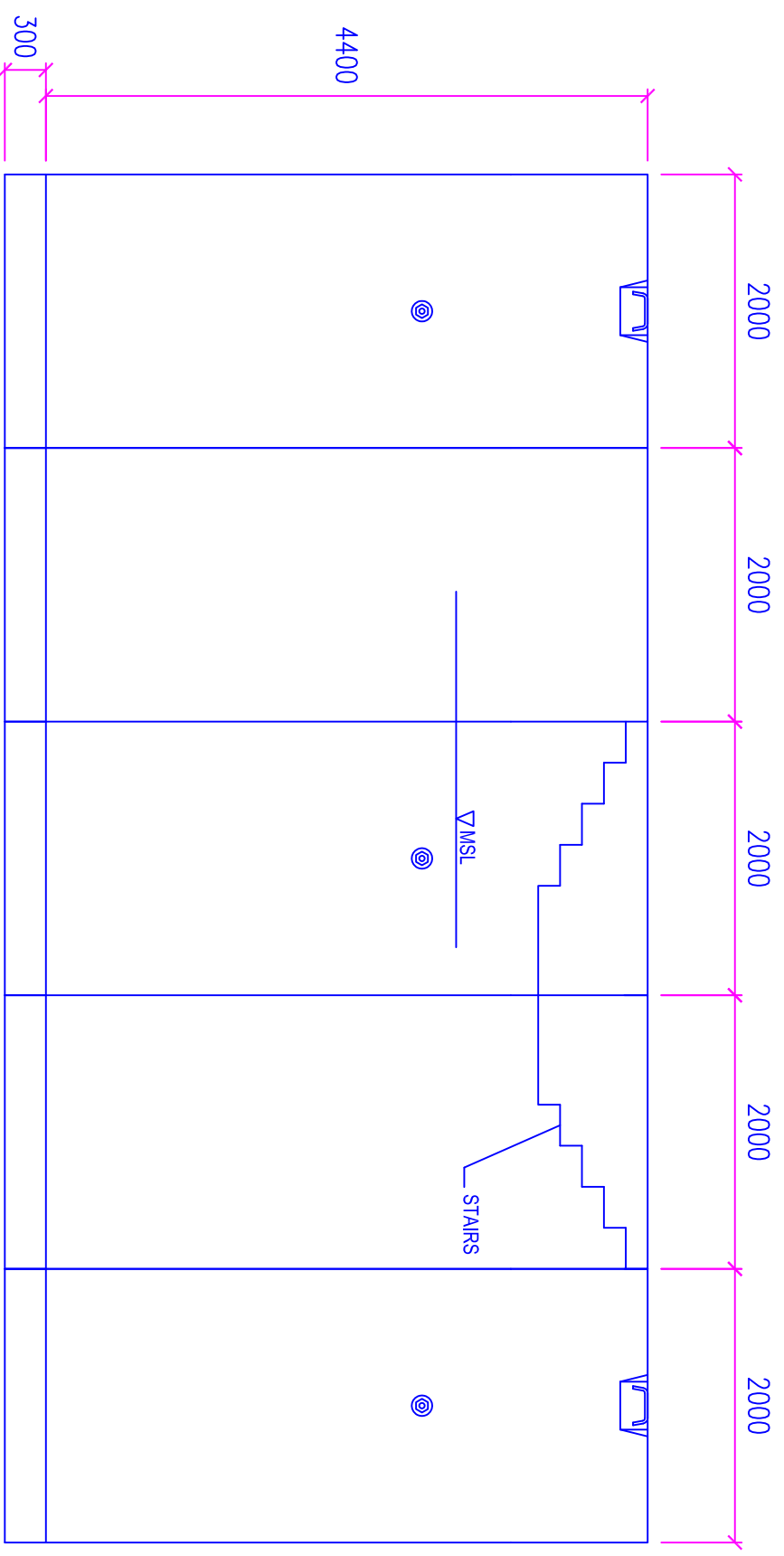

PROJECT:
CONSTRUCTION OF
L. FONADHOO HARBOUR

CONTENTS:
Quay Wall Staircase
Front Elevation

DRAWING NO.:
008

SCALE:
NTS

DATE:
24 FEBRUARY 2017

ENGINEERING DIVISION
MINISTRY OF HOUSING AND INFRASTRUCTURE
REPUBLIC OF MALDIVES
TEL: 300 4300, FAX: 300 4301

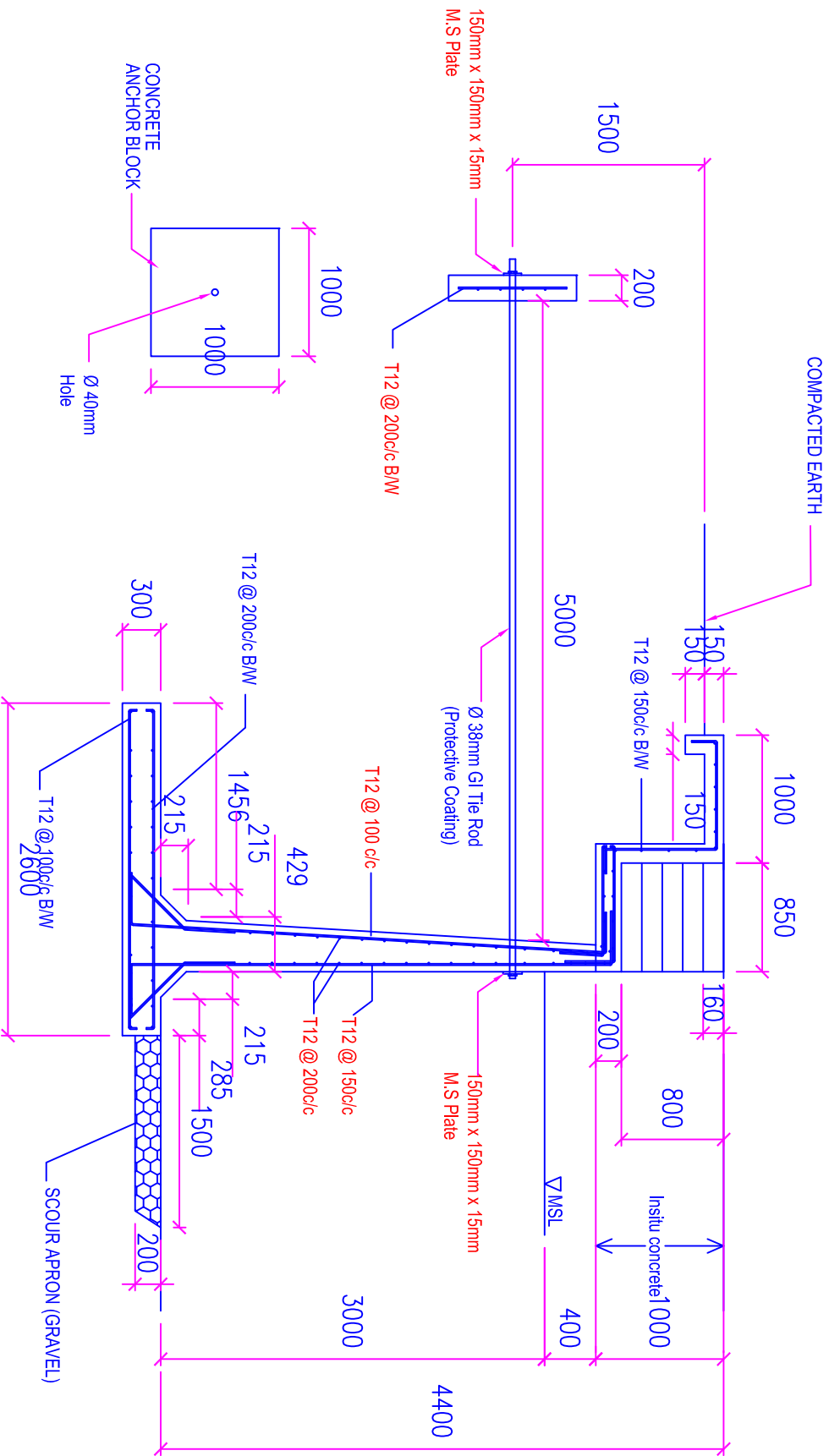

STAIR DETAIL

SCALE 1 : 50

PROJECT:

CONSTRUCTION OF
L. FONADHOO HARBOUR

CONTENTS:

Quay Wall Stair Detail

DRAWING NO.:

009

SCALE:

NTS

DATE:

24 FEBRUARY 2017



ENGINEERING DIVISION
MINISTRY OF HOUSING AND INFRASTRUCTURE
REPUBLIC OF MALDIVES
TEL: 300 4300, FAX: 300 4301