

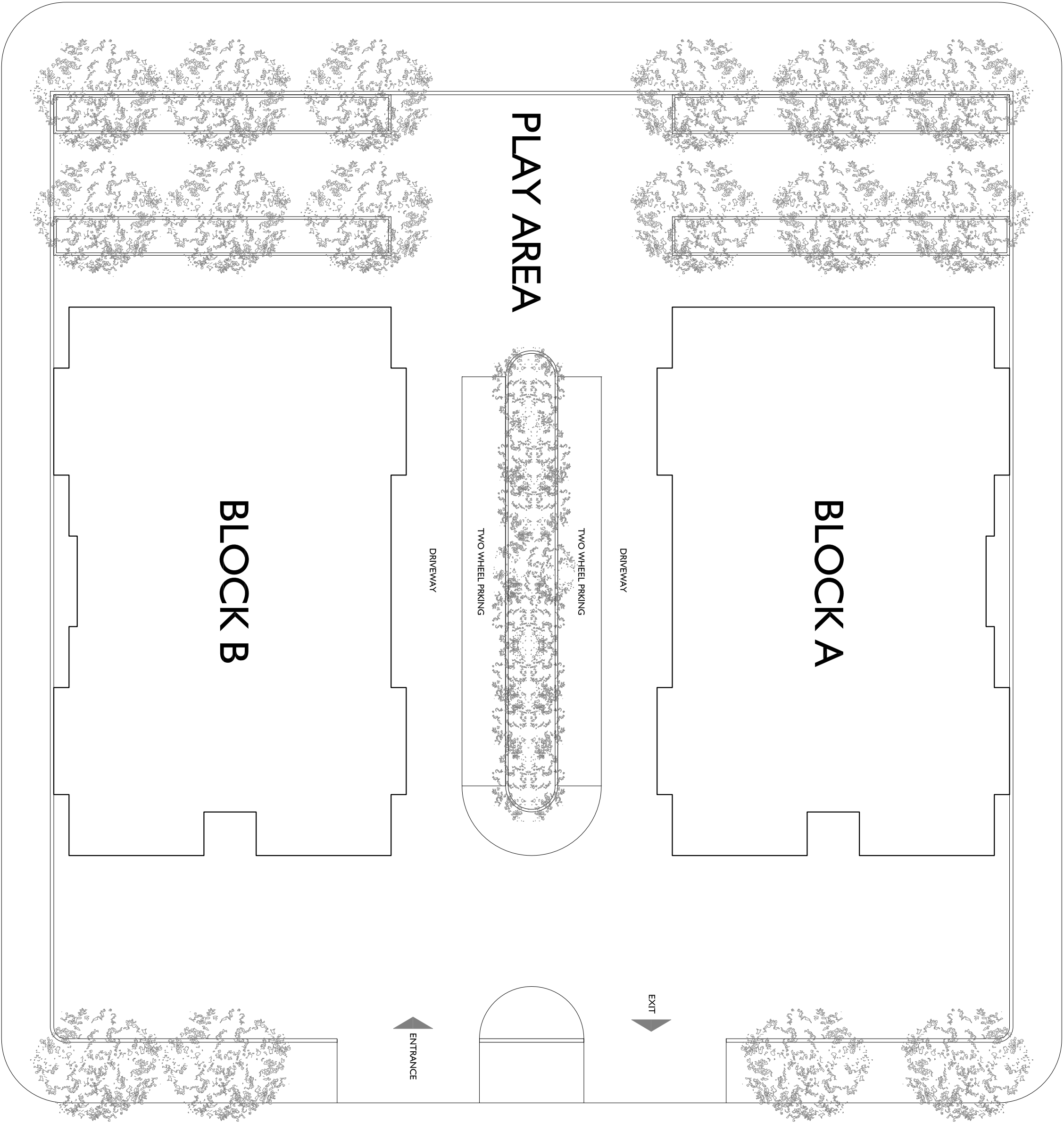

# CONCEPTUAL DESIGN FOR DH. KUDAHUVADHOO



CHECKER:	AMENDMENTS:	
ARCH. DESIGN: THOLHATH		
STRUC. DESIGN:		
DRAWN BY: THOLHATH		
DATE: MARCH 2018		
CLIENT: MHI		
NOTES:		

PROJECT:		DBF 750 HOUSING PROJECT IN 8 SELECTED ISLANDS	
CONTENTS:		SITE PLAN	
SCALE:	NS	DWG. NO.: A01/07	
FILE:			
 MINISTRY OF HOUSING & INFRASTRUCTURE INFRASTRUCTURE DEPARTMENT ADDRESS: WAZI, WAFAANU, MALÉ, 20392, REPUBLIC OF MALDIVES TEL: +960 3004300, FAX: +960 3004301			