

ADDENDUM 5

5 ۵۱۵۴۴
۵۱۵۴۴

سرشماره No:	TES/2020/W-065-R02		
ފޮޓޮއިން ނަންބަރު Project:	Design and Build of Proposed School -2 in Hulhumale’ Phase II, under EPC Turnkey Basis- Contractor Finance		
ބަންދުވުމުގެ ދުވަހު Issued Date	December 14, 2021		
ސަފުހާގެ އަދަދު No. of Pages: -5	ބޯޕްލާނު BoQ: -0	ޖަހާލުމުގެ އަދަދު Drawings: -0	

Please include this Addendum when submitting the bid.

- **Below listed drawings are issued with this addendum**
 - Location Map
 - Site Context
 - Plot Map
 - Setback Plan



٥٠

Name: **Fathimath Rishfa Ahmed**

 $\frac{x}{1}$

Signature:



PLANNING AND DEVELOPMENT DEPARTMENT
3RD FLOOR, HDC BUILDING HULHUMALE'
REPUBLIC OF MALDIVES
TEL. +(960)3353535, FAX +(960)3358892
EMAIL : planning@hdc.com.mv

PROJECT: School (N4-23)

Scale: N.T.S

Drawn by: Shahud

Checked by:



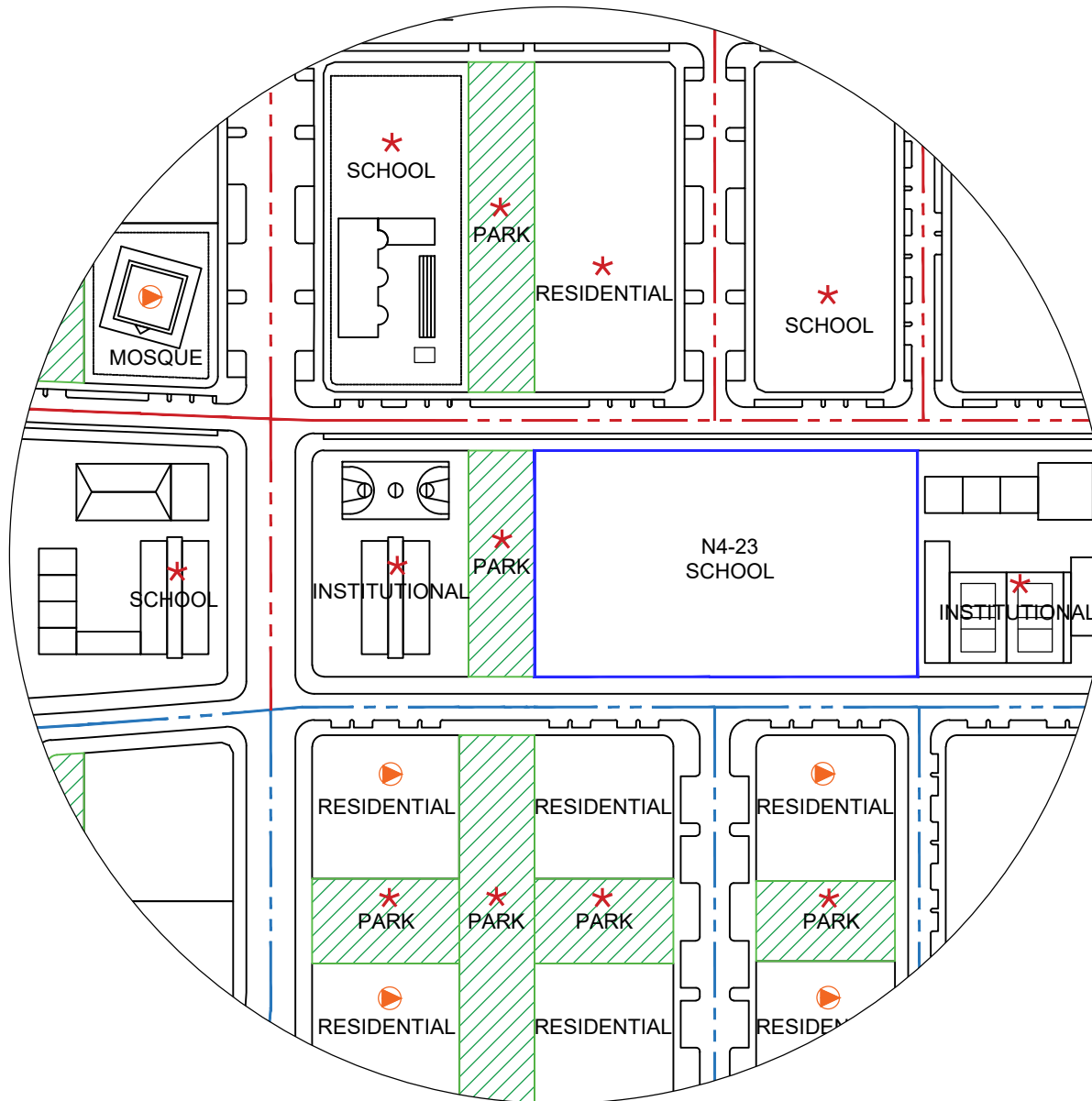

Date: 5th August 2020

Remarks:

DRAWING: LOCATION MAP



LEGEND:

-  COMPLETED
-  ONGOING
-  PLANNED
-  ROADS (COMPLETED)
-  ROADS (PLANNED)
-  GREEN LINK (PLANNED)



PLANNING AND DEVELOPMENT DEPARTMENT
3RD FLOOR, HDC BUILDING HULHUMALE'
REPUBLIC OF MALDIVES
TEL. +(960)3353535, FAX +(960)3358892
EMAIL : planning@hdc.com.mv

PROJECT: School (N4-23)

Scale: N.T.S

Drawn by: Shahud

Checked by:

Date: 5th August 2020

Remarks:

DRAWING: SITE CONTEXT



E 338600.6270
N 467016.1442

E 338572.9964
N 466918.5045

ROAD
101.47M

PARK
60.00M

N4-23
LOT 20419
AREA = 6,088.37 SQM
(65,534.61 SQFT)

60.00M
PROPOSED INSTITUTIONAL

E 338542.8946
N 467032.4814

101.47M
ROAD

E 338515.2641
N 466934.8419



PLANNING AND DEVELOPMENT DEPARTMENT
3RD FLOOR, HDC BUILDING HULHUMALE'
REPUBLIC OF MALDIVES
TEL. +(960)3353535, FAX +(960)3358892
EMAIL : planning@hdc.com.mv

PROJECT: School (N4-23)

DRAWING: PLOT MAP

Scale: N.T.S

Drawn by: Shahud

Checked by:

Date: 5th August 2020

Remarks:

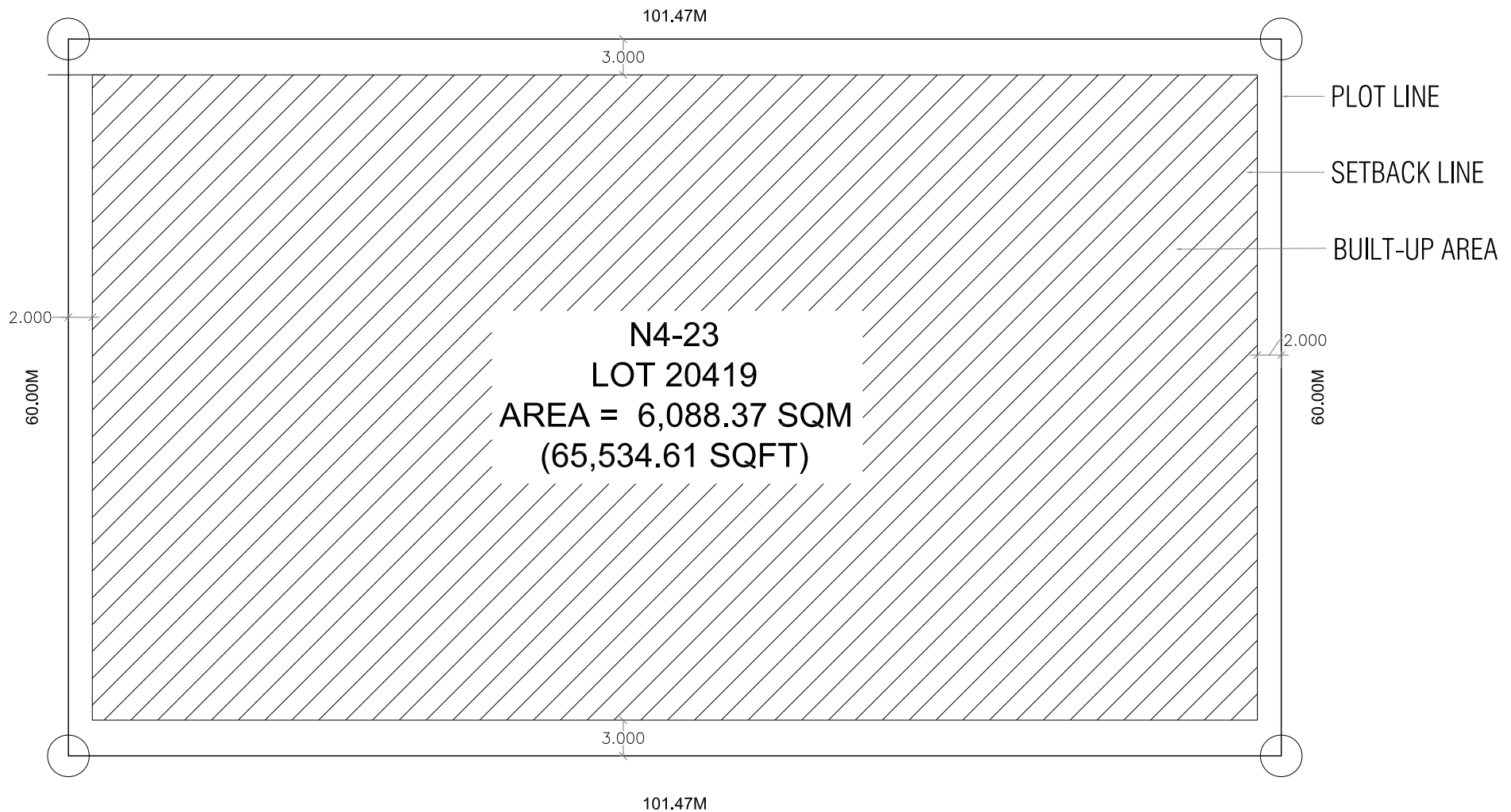

Lot Number	Parcel Number	Description	Land Use	Plot Area	Foot Print	Gross Floor Area (G.F.A)	Plot Ratio (F.S.I)	Site Coverage	Max Height / Floors
20419	N4-23	School	Educational	6,088.37 SQM	3,653.02 SQM	24,353.48 SQM	4.00	60%	6 Floors / 21.5m
				65,534.61 SQFT	39,320.76 SQFT	262,138.42 SQFT			21.5m bldg + 4m Lift Machine Room