

TREATED WATER TANK & FOUNDATION PLAN

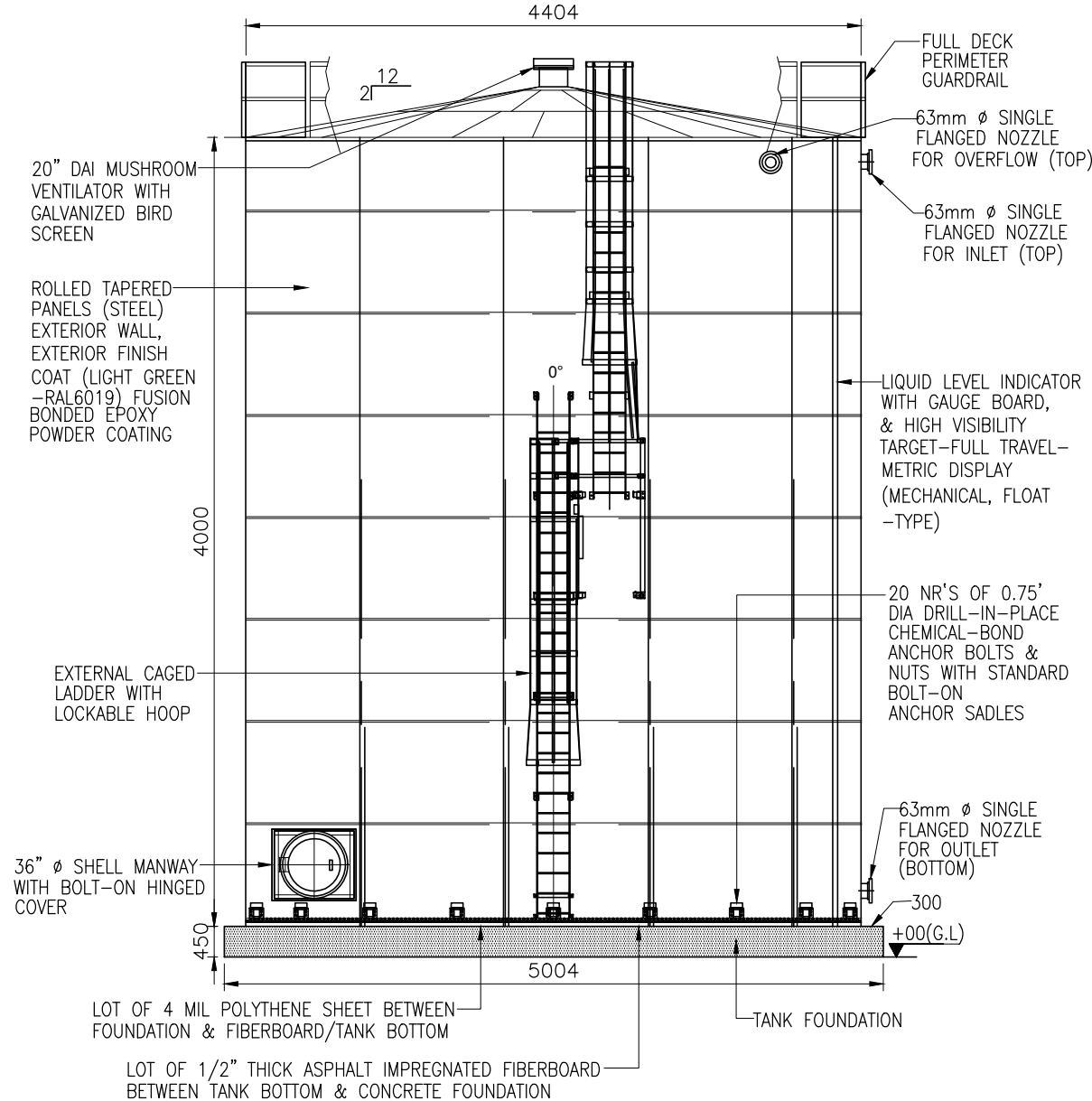

TREATED WATER TANK & FOUNDATION-ELEVATION

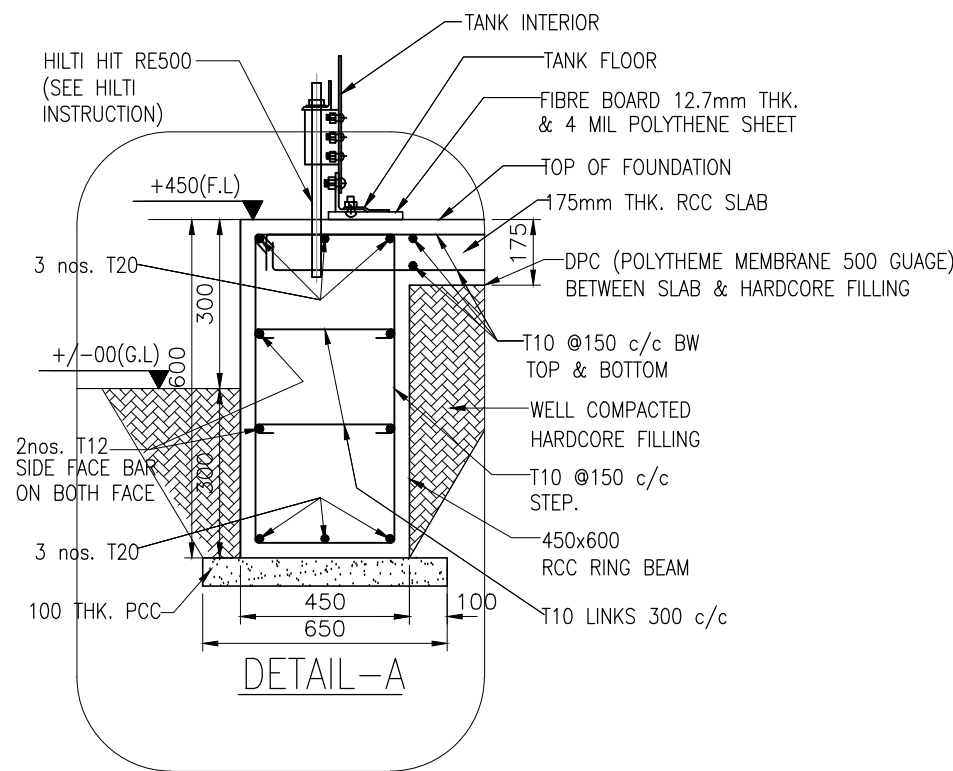
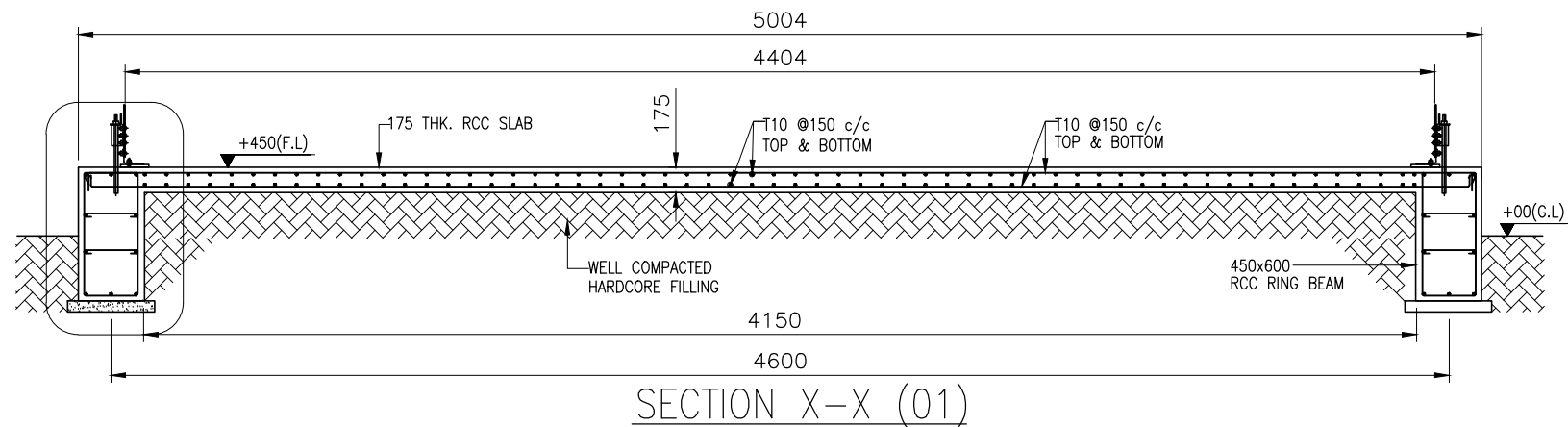

NOTES:-

- ALL DIMENSIONS ARE IN MILLIMETRES AND ALL LEVELS AER IN METRES, UNLESS OTHERWISE NOTED.
- DRAWINGS ARE NOT TO BE SCALED. ONLY WRITTEN DIMENSIONS ARE TO BE FOLLOWED.
- ALL CONCRETE WORK SHALL BE DESIGN GRADE C30.
- BLINDING CONCRETE WORK SHALL BE GRADE C10.
- ALL STRUCTURE WORK SHALL CONFORM TO BS 7668. GRADE 46A/ASTMA36. ALL STRUCTURAL MEMBERS SHALL BE HOT DIP GALVANIZED AND PAINTED AS PER SPECIFICATIONS.
- STEEL BARS DENOTED "T" SHALL BE HYSB BARS OF GRADE 460 CONFIRMING TO BS 4449
- NET SBC OF 15T/SQM IS CONSIDERED IN THE DESIGN.
- CLEAR COVER TO REINFORCEMENT
 - BEAM -40mm
 - SLAB -25mm



VIVEK V. PAGNIS
(STRUCTURAL ENGINEER)

TENDER PURPOSE

CLIENT				MINISTRY OF ENVIRONMENT AND ENERGY MALE REPUBLIC OF MALDIVES			
PROJECT				PROVISION OF RAINWATER HARVESTING SYSTEM IN 10 ISLANDS			
ASSIGNMENT				CONSULTANCY SERVICES FOR DESIGN AND SUPERVISION OF RAINWATER HARVESTING SYSTEM IN HA, UTHEEMU, HA, MULHADHOO, HA, MURADHOO, HA, ULIGAMU, HA, MAARANDHOO, HA, FILLADHOO, HDH, FINEY, HDH, KURINBI, HDH, NEYKURENDHOO, HDH, HIRIMARADHOO, MALDIVES [PACKAGE - 1]			
DRAWING TITLE				TYPICAL DRAWING OF TREATED WATER STORAGE TANK			
APPROVED				VVP	SSS	SPP	PDP
SCALE				AS SHOWN	DATE	FEB 2018	REVISION
DRAWING NUMBER				Hdh. Kurinbi /WS/08B			
0							